

DIVERSOS

CATÁLOGO DE COMPONENTES

SUMÁRIO

GABARITO / TINTEIRO / DISCO	PG. 2
MIOLO / VISOR	PG. 3
BUCHA EM TEFLON / BUCHA EM P.U.	PG. 4-6
COXIM	PG. 6-7
AMORTECEDOR	PG. 8
ROLO DEPELADOR	PG. 9-10
LÂMINA	PG. 10-11
PONTEIRA INFERIOR, PONTEIRA SUPERIOR	PG. 12
BICO C/ ROSCA, DESCAROÇADOR DE AZEITONA....	PG. 13
ROLETE, BICO GRAXEIRO, RETENTOR	PG. 14-16
ABRAÇADEIRA, PINO, ASSENTO, ROLDANA	PG. 17-20
ANEL ELÁSTICO, SUPORTE EM NYLON, MANCAL PARA ROLAMENTO, FOLE	PG. 21-24
GUIA, PERFIL GUIA P/ CINTA, EIXO ROSCADO	PG. 25-26
LÂMINA DE CORTE, SELO MECÂNICO	PG. 27-28



DIVERSOS

GABARITO / TINTEIRO / DISCO.....PG.2

EMBOLO / VISOR.....PG.3

BUCHA EM TEFLON / BUCHA EM P.U.....PG.4-6

COXIM.....PG.6-7

AMORTECEDOR.....PG.8

ROLO DEPELADOR.....PG.9-10

LAMINA.....PG.10-11

PONTEIRA INFERIOR, PONTEIRA SUPERIOR.....PG.12

BICO C/ ROSCA, DESCAROÇADOR DE AZEITONA....PG.13

ROLETE, BICO GRAXEIRO, RETENTOR.....PG.14-16

ABRAÇADEIRA, PINO, ASSENTO, ROLDANA.....PG.17-20

ANEL ELÁSTICO, SUPORTE EM NYLON, MANCAL PARA ROLAMENTO, FOLE.....PG.21-24

GUIA, PERFIL GUIA P/ CINTA, EIXO ROSCADO....PG.25-26

LÂMINA DE CORTE, SELO MECÂNICO.....PG.27-28

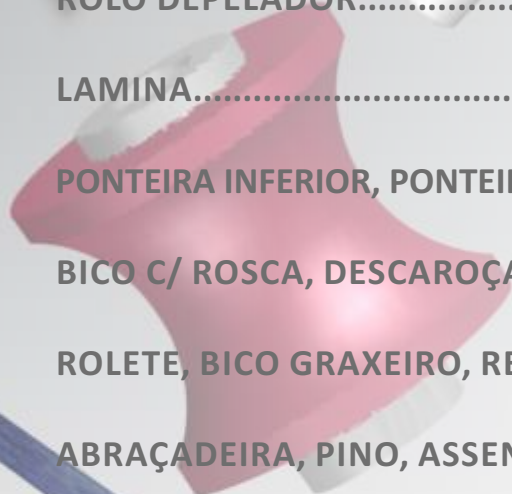
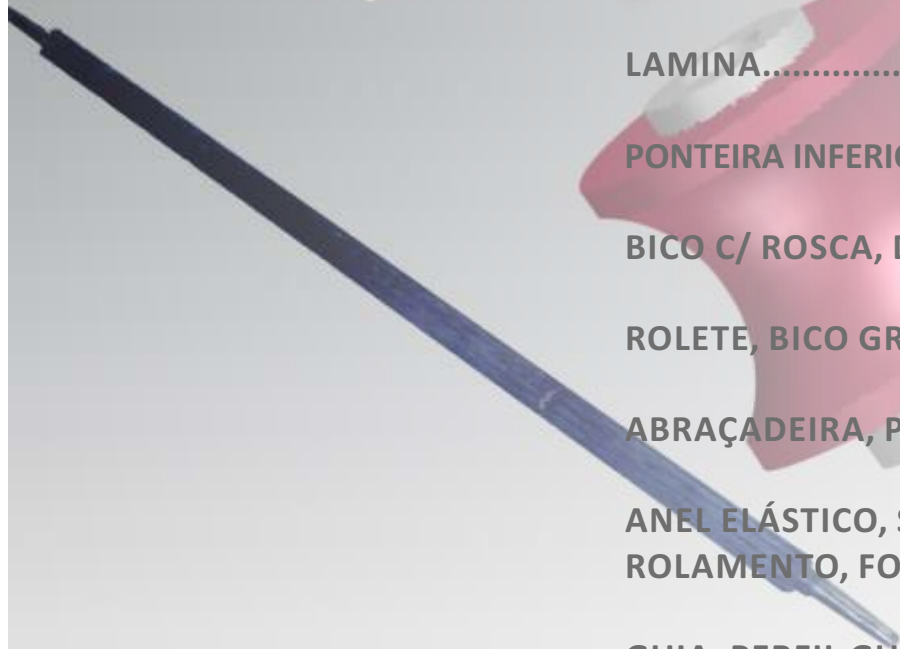
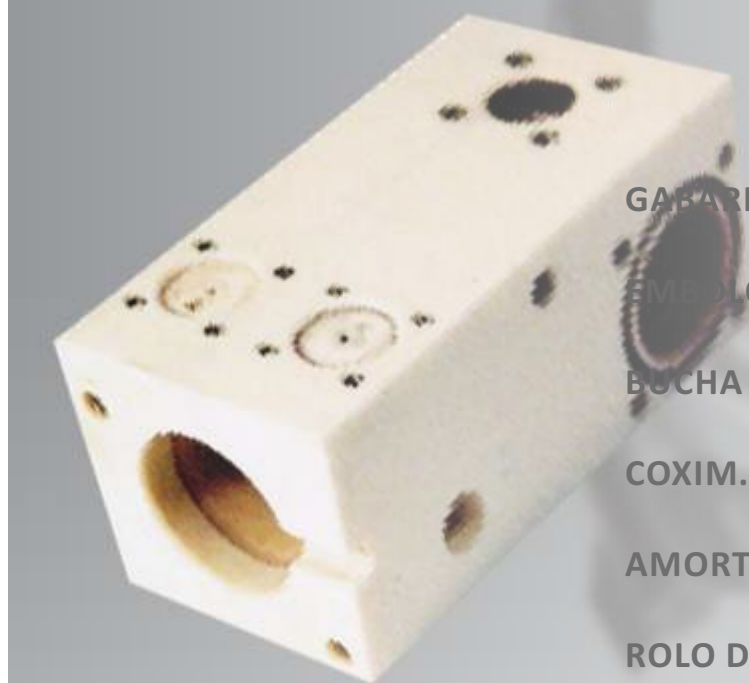

DIVERSOS

GABARITO HEAD SPACE

Código	ml	Material
CSB 5758	290	Acrílico
CSB 1712	600	
CSB 5363	1000	

SEPARADOR TOP STAR ESQUERDO/DIREITO

Código	A	ml	Material
CSB 0985	101	300	P.P.
CSB 0986	101	500	
CSB 0984	140	1250	

GABARITO PASSA - NÃO PASSA

Código	Material
CSB 5465	Aço Inox

DISCO

Código	A	B	Material
CSB 3201	12	5,5	P.U.
CSB 3257	18	2	
CSB 4376	16	2,5	

ROTOR

Código	A	B	C	D	Material
CSB 0980	116	80	60	10,5	Nitrílica
CSB 1633	67	48	34	7	
CSB 1680	97	63	60	5	
CSB 1681	127	103	79	10,5	
CSB 2137	120	93	65	13,5	

DISCO

Código	Material
CSB 1727	Nitrílica

TINTEIRO

Código	Material
CSB 1751	Poliacetal

BOLA

Código	A	Material
CSB 1277	75	Nitrílica ou P.U. com Miolo de Aço
CSB 2086	102	
CSB 3667	136	
CSB 3866	63,5	
CSB 4083	26	

DIVERSOS

BORRACHA CÔNICA PARA VACUÔMETRO - GRANDE

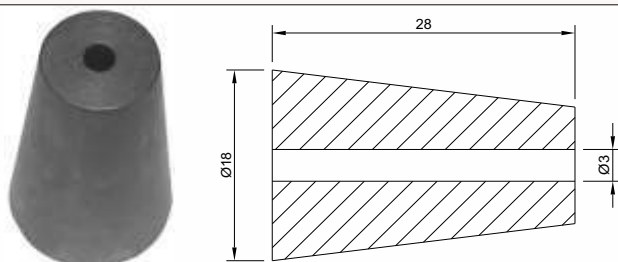

Código
CSB 3592

Material
Nitrílica

ÊMBOLO DO PISTÃO

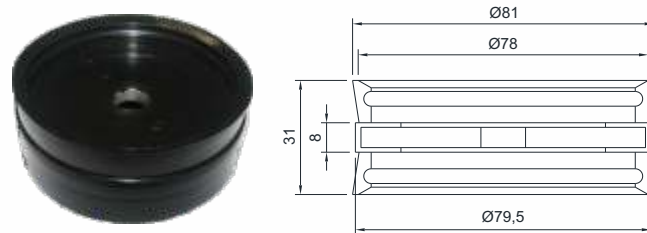

Código
CSB 10409

Material
Borracha Nitrílica

BORRACHA CÔNICA PARA VACUÔMETRO - PEQUENA

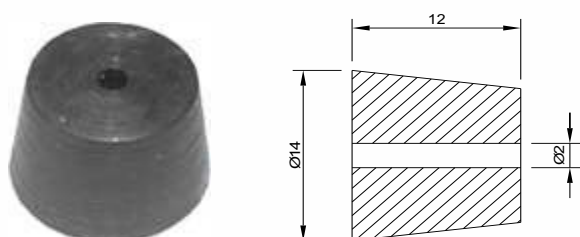

Código
CSB 3593

Material
Nitrílica

ÊMBOLO DO PISTÃO

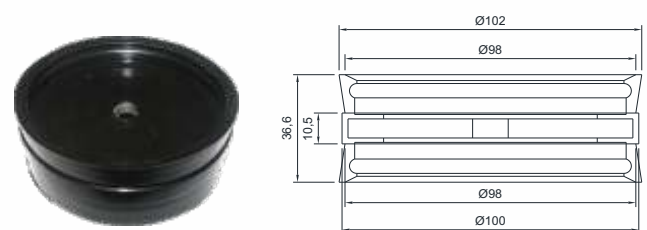

Código
CSB 10411

Material
Borracha Nitrílica

DEDO PELISCADOR

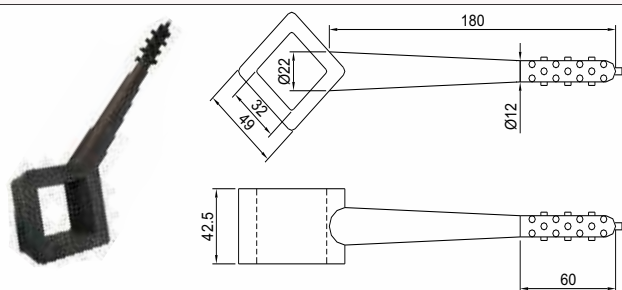

Código
CSB 1732

Material
Nitrílica

VISOR

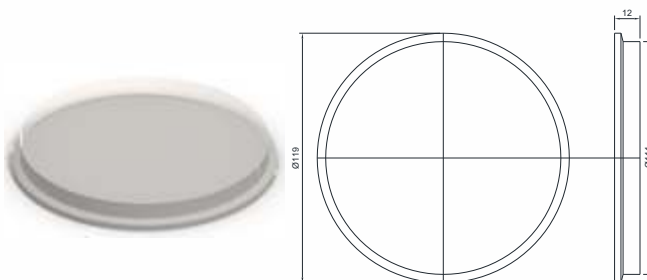

Código
CSB 7805

Material
Vidro

ROLETE ESTRIADO

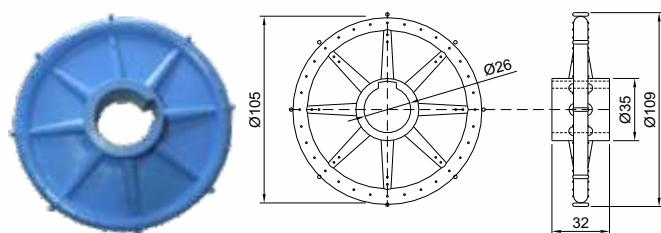

Código
CSB 1216

Material
Nitrílica

VISOR

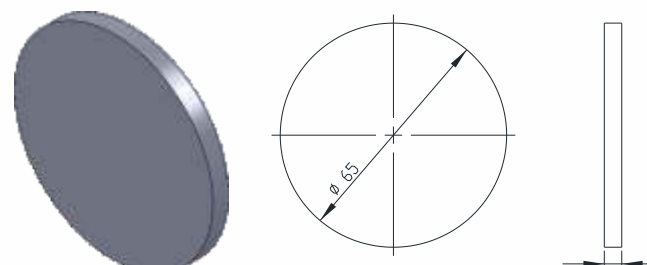

Código
CSB 8606

Material
Policarbonato Chapa

CASTROSUL INDÚSTRIA E COMÉRCIO DE PLÁSTICOS LTDA.

☎ (DXX) 41 3382-5016 ☎ (DXX) 41 3382-2643

🏠 WWW.CASTROSUL.COM.BR ✉ CASTROSUL@CASTROSUL.COM.BR

RUA D. PEDRO II, 506 • AFONSO PENA • VILA CENTENÁRIO DO SUL

CEP 83 050-250 • SÃO JOSÉ DOS PINHAIS • PARANÁ • BRASIL

DIVERSOS

BUCHA PARA MANCAL DE MOINHO

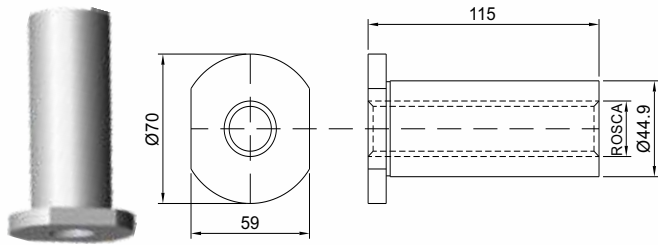

Código

CSB 3401

Material

Aço Inox Retificado

BUCHA DE TEFLON DOS VISORES 4"

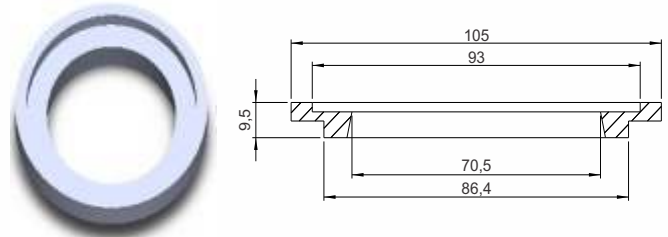

Código

CSB 5394

Material

Teflon

BUCHA PARTIDA

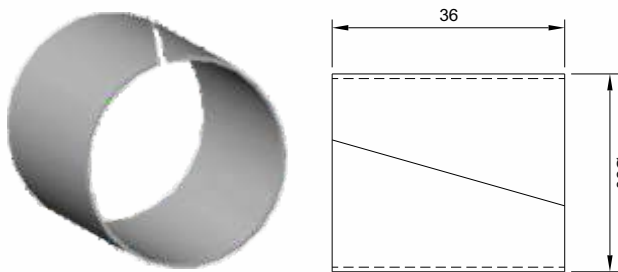

Código

CSB 3436

Material

Teflon

BUCHA DE TEFLON DOS VISORES 5"

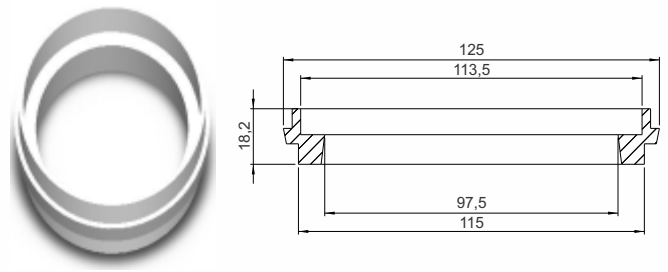

Código

CSB 5395

Material

Teflon

BUCHA INFERIOR DA SOPRADORA

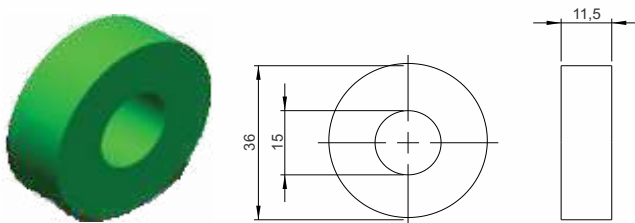

Código

CSB 5469 PA

Material

UHMW

BUCHA DE TEFLON DOS VISORES 3"

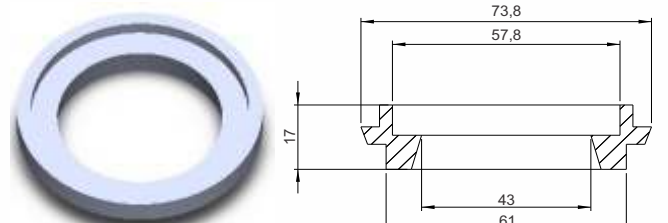

Código

CSB 5393

Material

Teflon

BUCHA

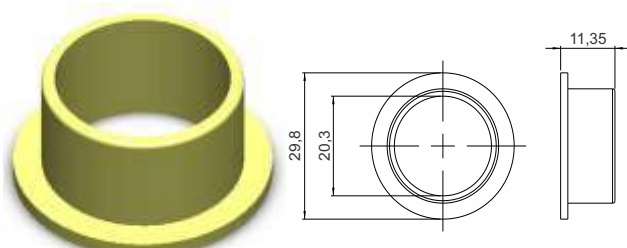

Código

CSB 5642

Material

Poliacetal

BUCHA DE P.U.

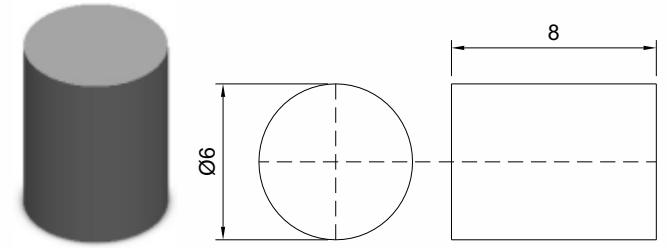

Código

CSB 5330

Material

P.U.

DIVERSOS

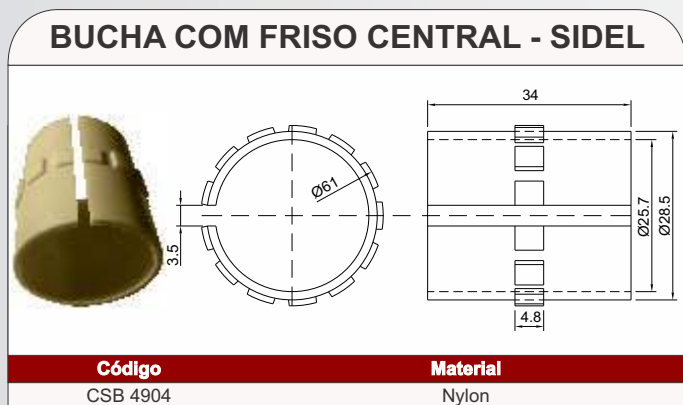
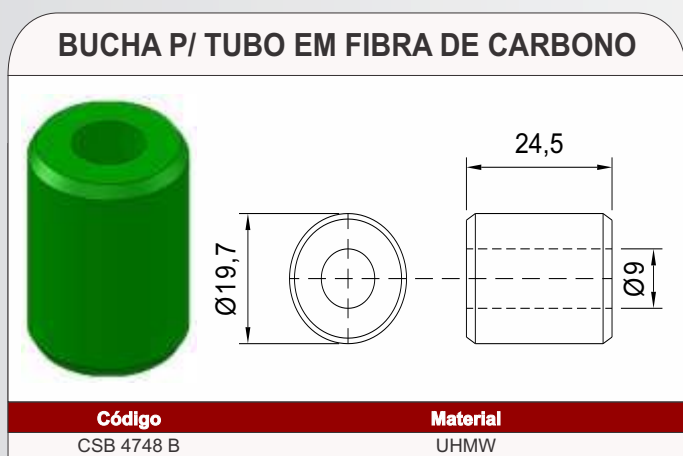
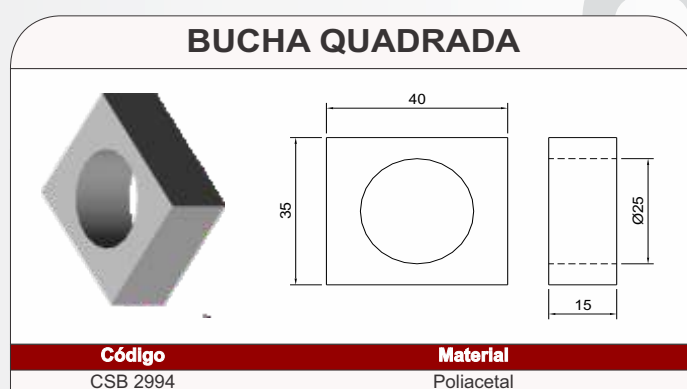
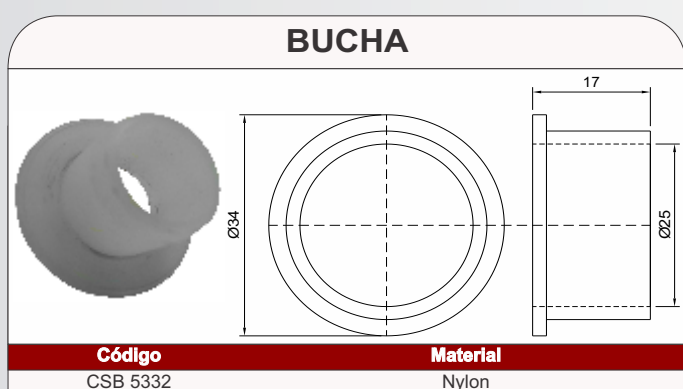
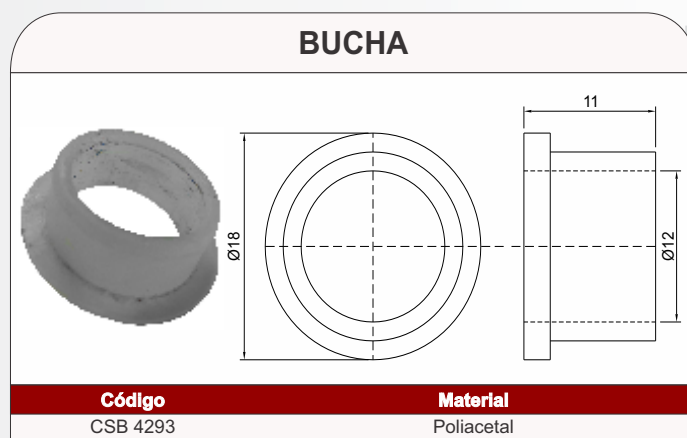
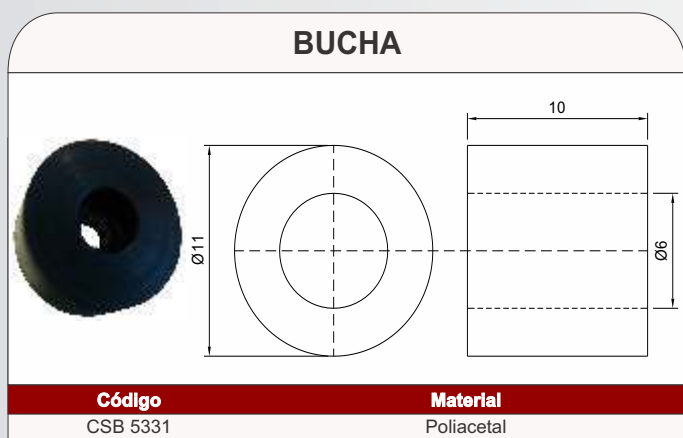

CASTROSUL INDÚSTRIA E COMÉRCIO DE PLÁSTICOS LTDA.

☎ (0XX) 41 3382-5016 📠 (0XX) 41 3382-2643

🏠 WWW.CASTROSUL.COM.BR ✉ CASTROSUL@CASTROSUL.COM.BR

RUA D. PEDRO II, 506 • AFONSO PENA • VILA CENTENÁRIO DO SUL

CEP 83 050-250 • SÃO JOSÉ DOS PINHAIS • PARANÁ • BRASIL

DIVERSOS

BUCHA

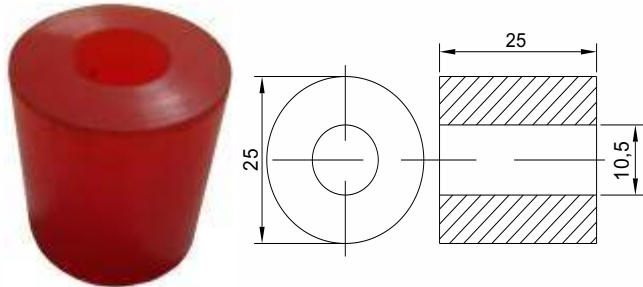

Código
CSB 4715

Material
P.U.

BUCHA BI-PARTIDA

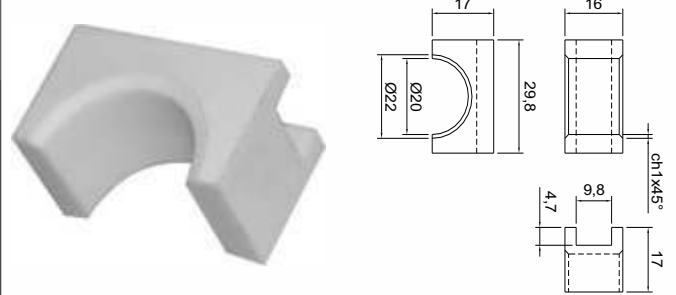

Código
CSB 2469

Material
Teflon com Fibra

BUCHA

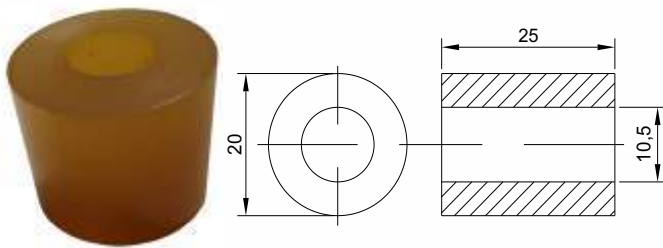

Código
CSB 4714

Material
P.U.

BUCHA PARA MANCAL DE MOINHO

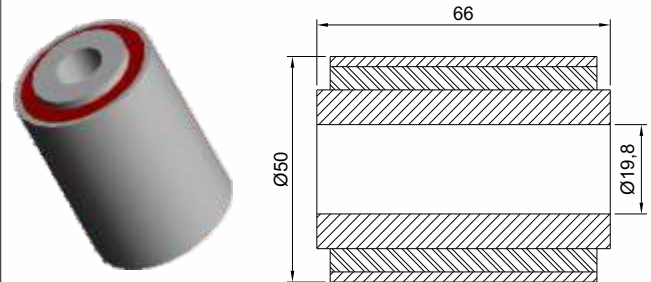

Código
CSB 3398

Material
Aço Inox e Nitrílica

BUCHA DE ENROLADEIRA

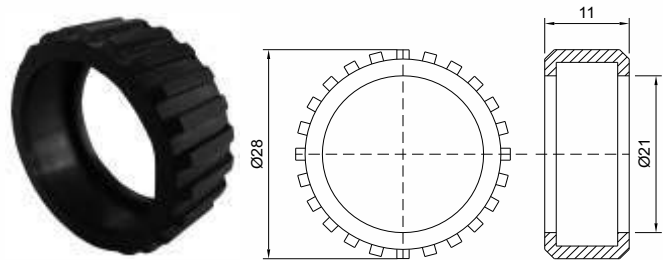

Código
CSB 4593

Material
Nitrílica

AMORTECEDOR

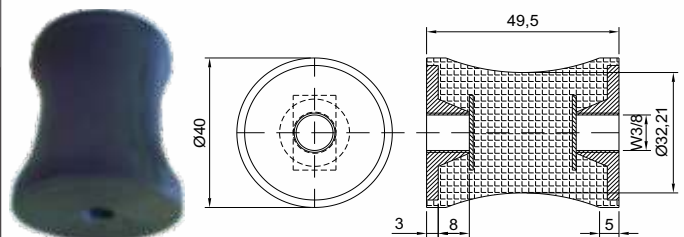

Código
CSB 2447

Material
Aço Inox e Nitrílica

BUCHA PARA BORBOLETA ACIONADORA

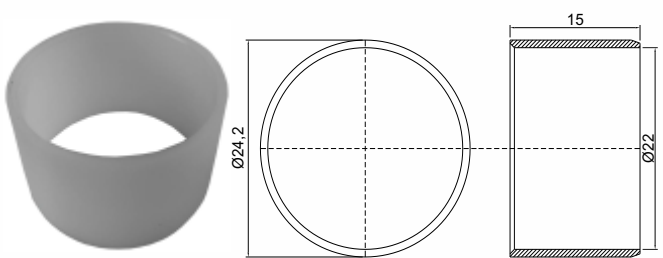

Código
CSB 4498

Material
Poliacetel

COXIM AMORTECEDOR

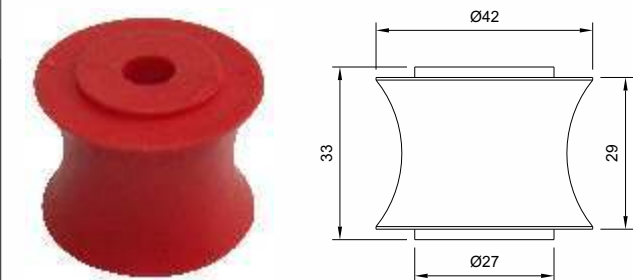

Código
CSB 4396

Material
Aço Inox e Nitrílica

DIVERSOS

COXIM AMORTECEDOR

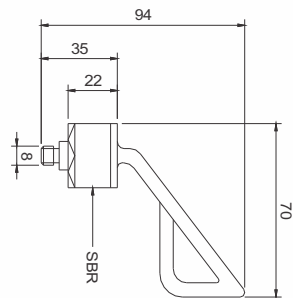

Código

CSB 0688

Material

Aço Inox/Nitrílica

COXIM AMORTECEDOR

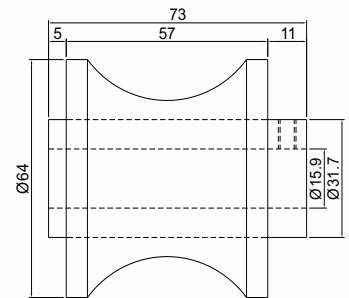

Código

CSB 3787

Material

Aço e Nitrílica

COXIM AMORTECEDOR

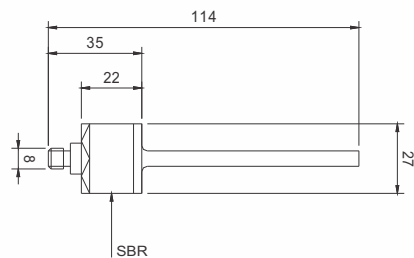

Código

CSB 0688 R

Material

Aço Inox/Nitrílica

COXIM

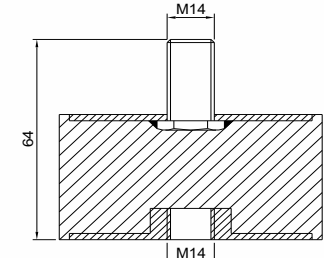
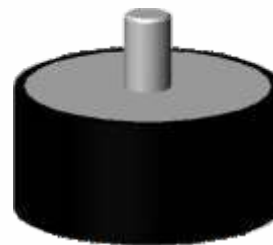

Código

CSB 3137

Material

Nitrílica e Aço SAE 1020

COXIM AMORTECEDOR

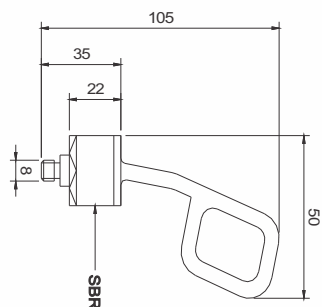

Código

CSB 0688 P

Material

Aço Inox/Nitrílica

COXIM

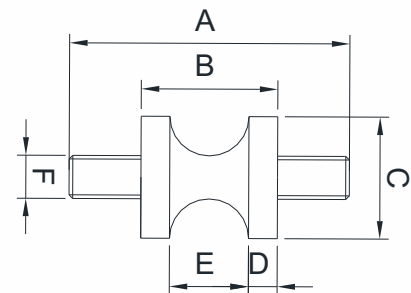

Código	A	B	C	D	E	F	Material
CSB 3160	56	26	30	5	16	M8	Nitrílica e Aço SAE 1020
CSB 12527	39	19	17	4	11	M6	

COXIM AMORTECEDOR

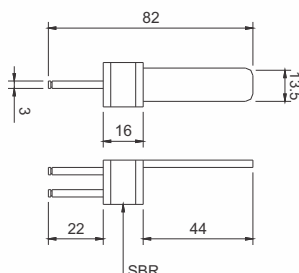

Código

CSB 0687

Material

Aço Inox/Nitrílica

BATENTE

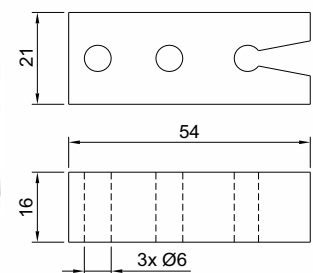

Código

CSB 3319

Material

UHMW

CASTROSUL INDÚSTRIA E COMÉRCIO DE PLÁSTICOS LTDA.

☎ (0XX) 41 3382-5016 ☎ (0XX) 41 3382-2643

🌐 WWW.CASTROSUL.COM.BR ✉ CASTROSUL@CASTROSUL.COM.BR

RUA D. PEDRO II, 506 • AFONSO PENA • VILA CENTENÁRIO DO SUL

CEP 83 050-250 • SÃO JOSÉ DOS PINHAIS • PARANÁ • BRASIL

DIVERSOS

BATENTE

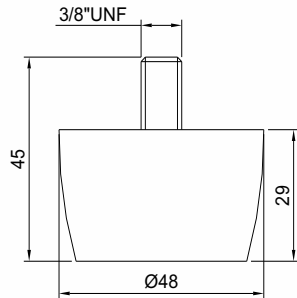

Código

CSB 2068

Material

Nitrílica 60/70 Shore "A" e Parafuso

ÊMBOLO

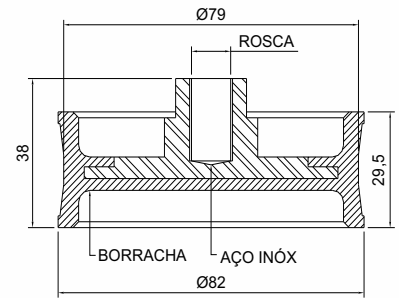

Código

CSB 3091

Material

Nitrílica/Aço Inox

AMORTECEDOR

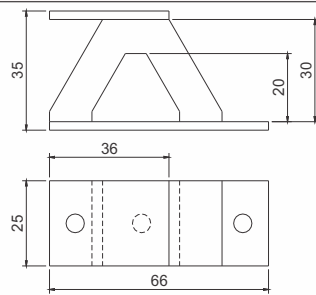

Código

CSB 1677

Material

Nitrílica e Aço Inox

ÊMBOLO

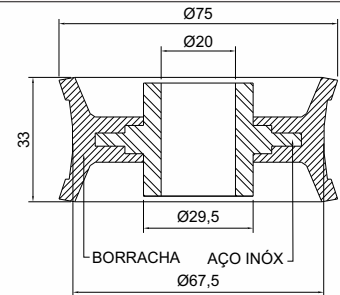

Código

CSB 2100

Material

Nitrílica/Aço Inox

AMORTECEDOR

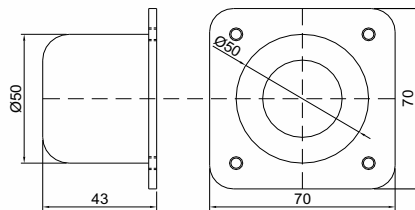

Código

CSB 7030

Material

Aço e Nitrílica

ÊMBOLO

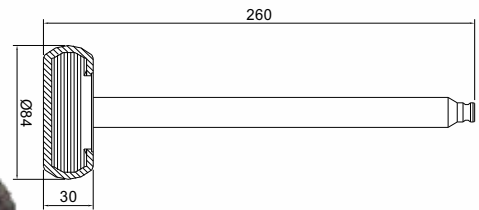

Código

CSB 0685

Material

Nitrílica/Aço Inox

AMORTECEDOR DA CALHA VIBRATÓRIA

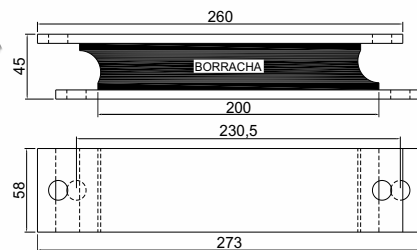

Código

CSB 3514

Material

Aço Inox e Nitrílica

ÊMBOLO

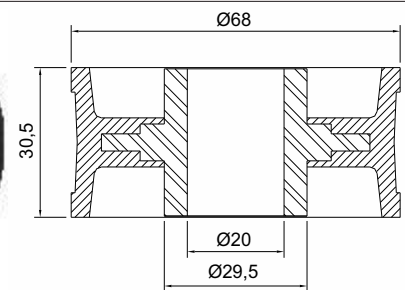

Código

CSB 3090

Material

Nitrílica/Aço Inox

DIVERSOS

ÊMBOLO

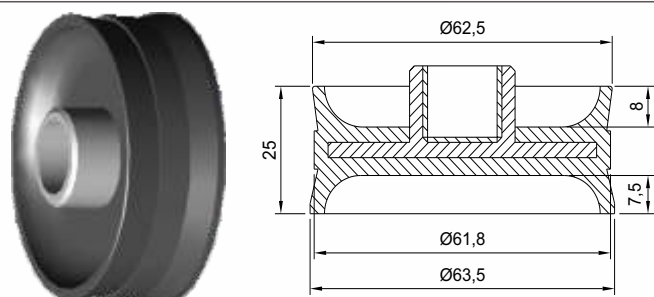

Código
CSB 3243

Material
Nitrílica/Aço Inox

COGINETE SUPERIOR

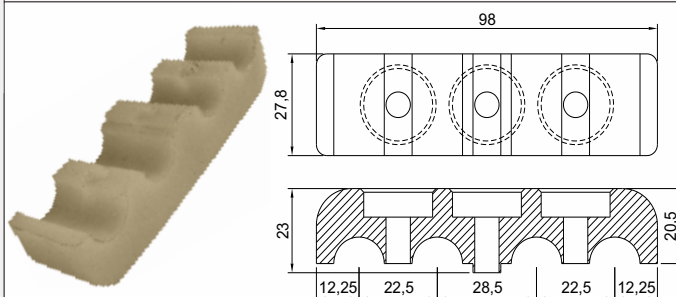

Código
CSB 3151

Material
Nylon

CRUZETA SUSPENSOR PARA TÚNEL DE RESFRIAMENTO

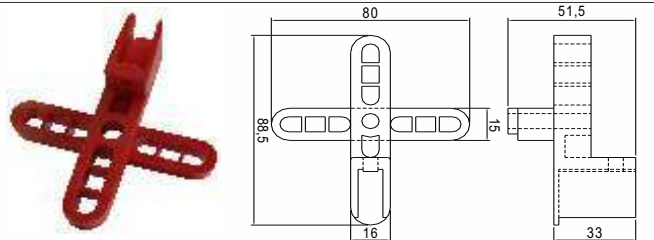

Código
CSB 3001

Material
Poliacetal

ROLO DEPELADOR DE TOMATE EIXO PEQUENO

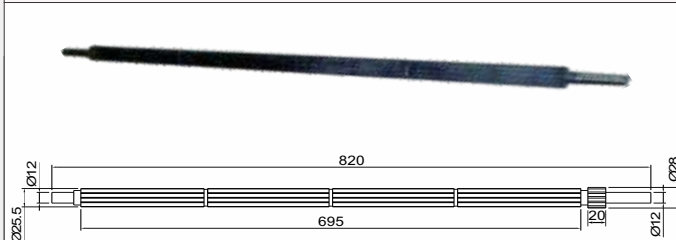

Código
CSB 1664

Material
Aço Inox e Nitrílica

PALLET ESTRADO PARA TÚNEL DE RESFRIAMENTO

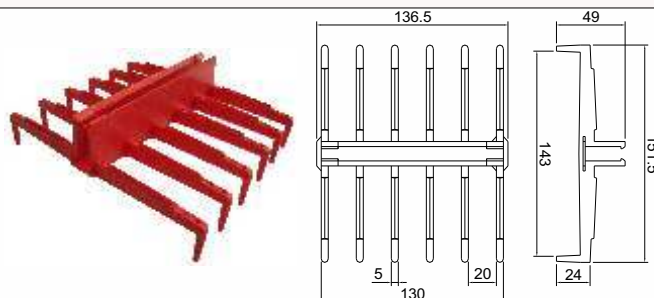

Código
CSB 3002

Material
Poliacetal

ROLO DEPELADOR

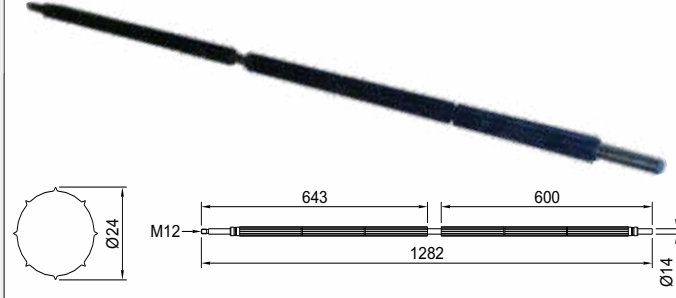

Código
CSB 1212

Material
Nitrílica/Aço 420

COGINETE INFERIOR

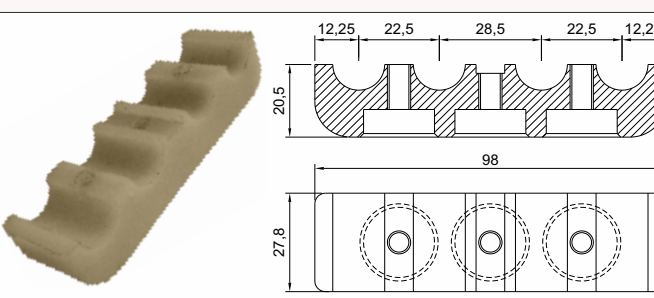

Código
CSB 3150

Material
Nylon

ROLO DEPELADOR

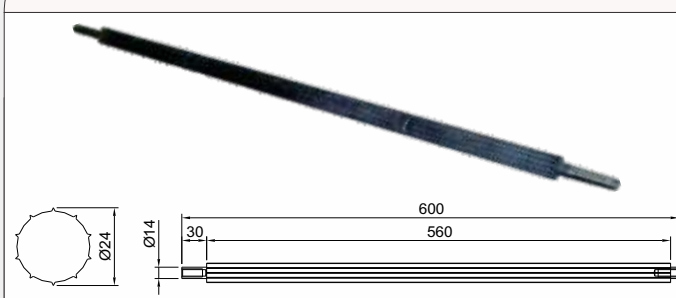

Código
CSB 1663 R

Material
Nitrílica/Aço 420

CASTROSUL INDÚSTRIA E COMÉRCIO DE PLÁSTICOS LTDA.

☎ (0XX) 41 3382-5016 ☎ (0XX) 41 3382-2643

🏠 WWW.CASTROSUL.COM.BR ✉ CASTROSUL@CASTROSUL.COM.BR

RUA D. PEDRO II, 506 • AFONSO PENA • VILA CENTENÁRIO DO SUL

CEP 83 050-250 • SÃO JOSÉ DOS PINHAIS • PARANÁ • BRASIL

DIVERSOS

ROLO DEPELADOR

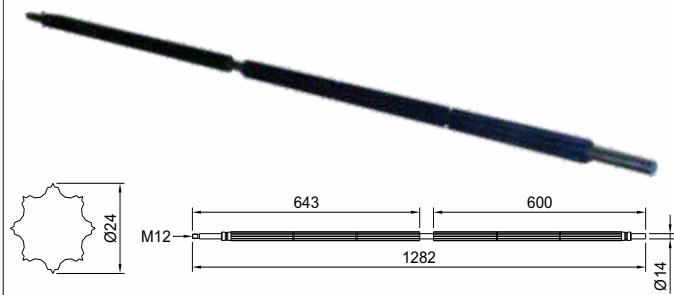

Código

CSB 1211

Material

Nitrílica/Aço 420

HASTE EXTRATORA

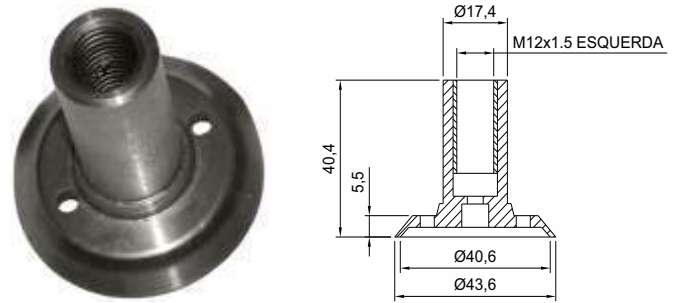

Código

CSB 0131

Material

Aço Inox Polido

ROLO DEPELADOR DE TOMATE EIXO DIREITO

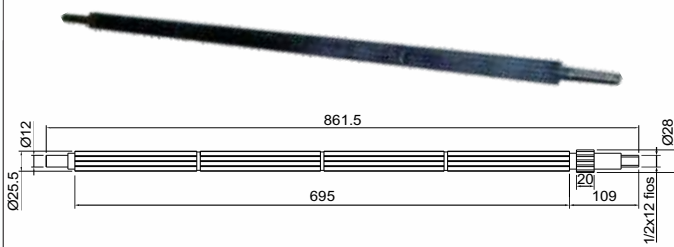

Código

CSB 1664 D

Material

Aço Inox e Nitrílica

CALÇO TUCHO

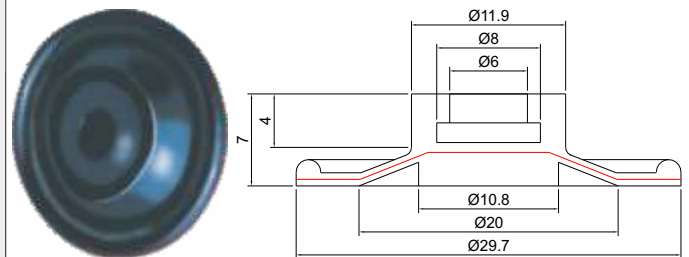

Código

CSB 0443

Material

Nitrílica

ROLO DEPELADOR DE TOMATE EIXO ESQUERDO

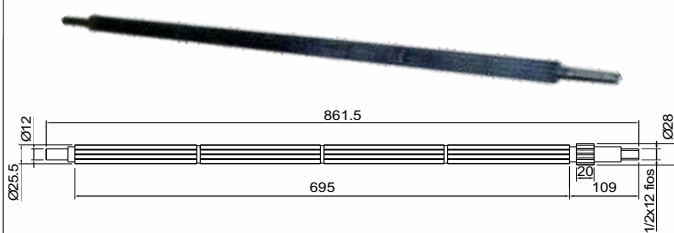

Código

CSB 1664 E

Material

Aço Inox e Nitrílica

MEMBRANA

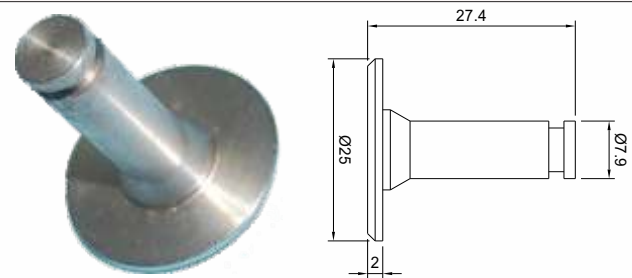

Código

CSB 0444

Material

Aço Inox Polido

BORRACHA DA VÁLVULA DE FILTRO

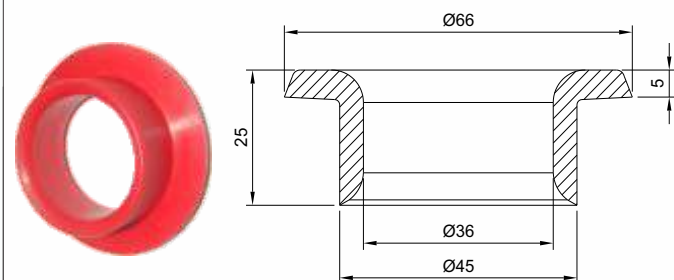

Código

CSB 2181

Material

Silicone Atóxico

LÂMINA

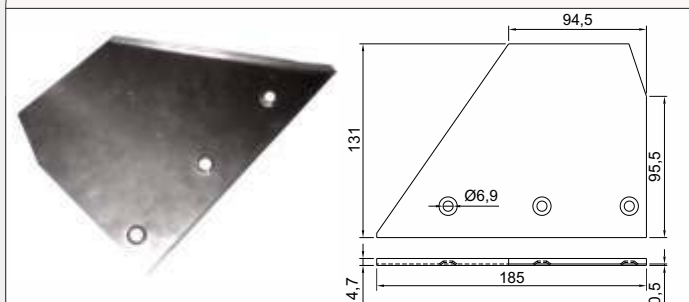

Código

CSB 0010 L

Material

Aço Inox Polido

DIVERSOS

LÂMINA

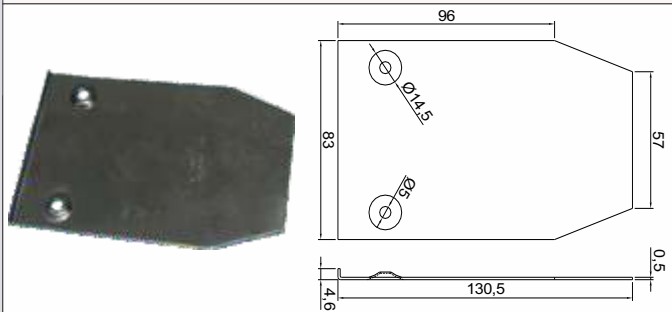

Código
CSB 0012

Material
Aço Inox Polido

CARRO MESA DIVISORA DE BISCOITO

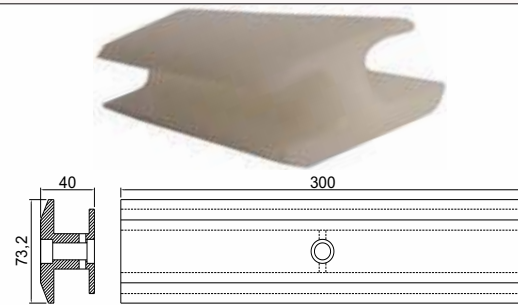

Código
CSB 3802

Material
UHMW

LÂMINA

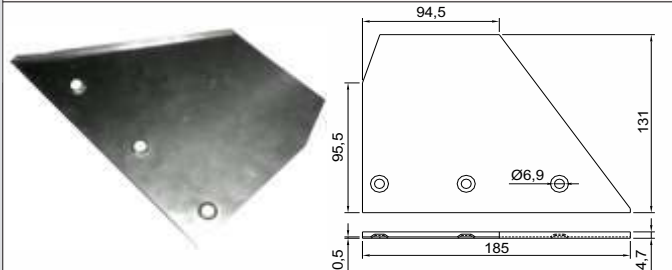

Código
CSB 0011 L

Material
Aço Inox Polido

BATENTE PARA CARROSSEL

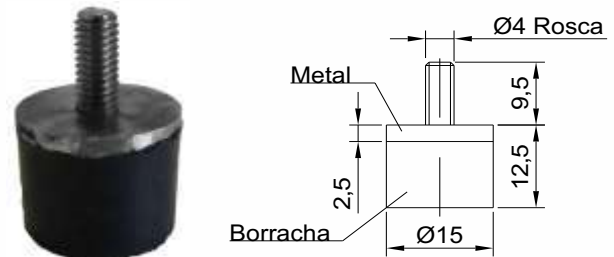

Código
CSB 4787

Material
EPDM

ROTOR

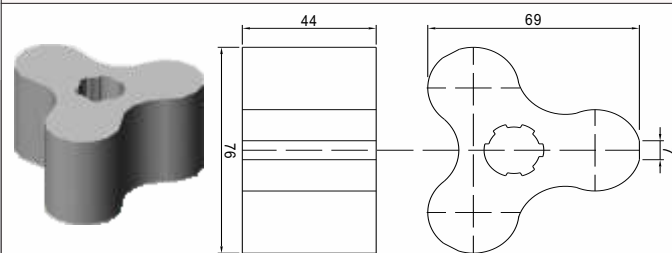

Código
CSB 10 RT

Material
Aço Inox Polido

LUA DE BORRACHA

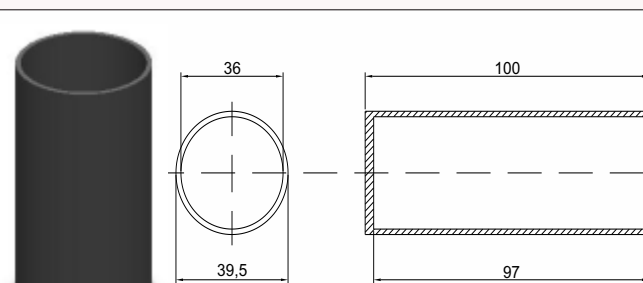

Código
CSB 4793

Material
EPDM

SEPARADOR DE BISCOITO RECHEADO

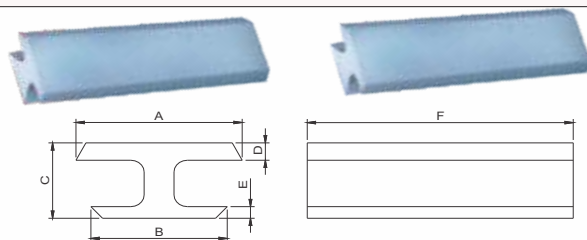

Código	A	B	C	D	E	F	Material
CSB 0007	24,5	19,6	14	5	2	80	UHMW
CSB 0962	24,5	19	15,5	4	4	80	
CSB 1557	24	17	14	3,7	3,3	80	
CSB 1558	24,5	19,6	14	5	2	80	
CSB 1559	24,5	19,6	14	3,25	3,25	80	
CSB 1560	25	20,5	13	3	2	80	
CSB 1561	25	20,5	13	2,5	2,5	80	

SUPORE PLÁSTICO

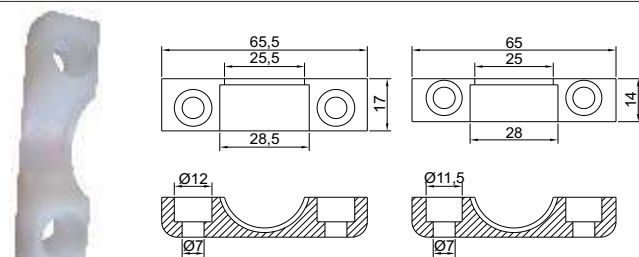

Código
CSB 4885

Material
P.P.

CASTROSUL INDÚSTRIA E COMÉRCIO DE PLÁSTICOS LTDA.

☎ (0XX) 41 3382-5016 ☎ (0XX) 41 3382-2643

🏠 WWW.CASTROSUL.COM.BR ✉ CASTROSUL@CASTROSUL.COM.BR

RUA D. PEDRO II, 506 • AFONSO PENA • VILA CENTENÁRIO DO SUL

CEP 83 050-250 • SÃO JOSÉ DOS PINHAIS • PARANÁ • BRASIL

DIVERSOS

PRATO COM LONA

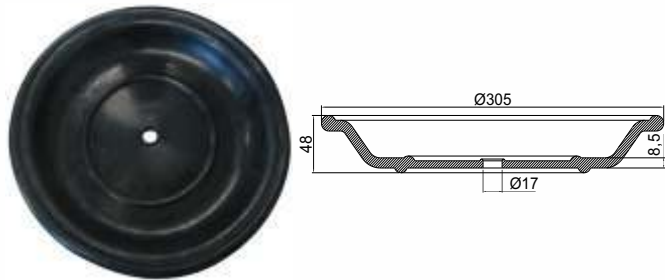

Código
CSB 1026

Material
Borracha Natural

PORCA 1/4"

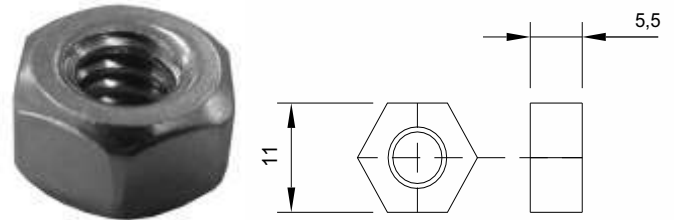

Código
CSB 5623

Material
Aço Carbono 1020 Zincado

PONTEIRA INFERIOR

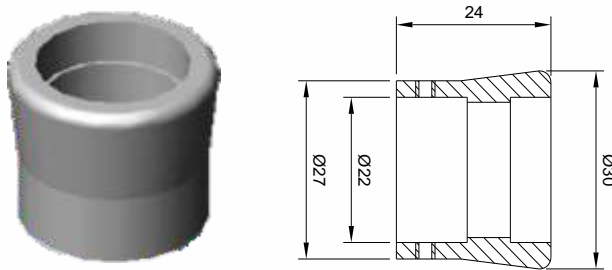

Código
CSB 3438

Material
Poliacetal

ROLO DE BORRACHA

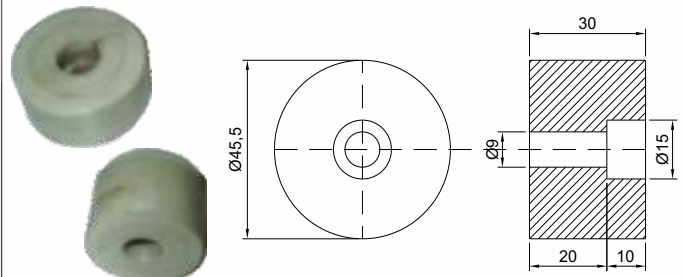

Código
CSB 2449

Material
Nitrílica

PONTEIRA SUPERIOR

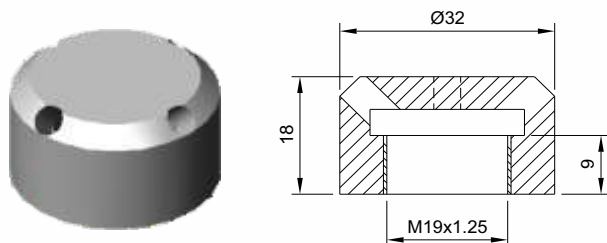

Código
CSB 3437

Material
Poliacetal

PROTEÇÃO PARA PINO

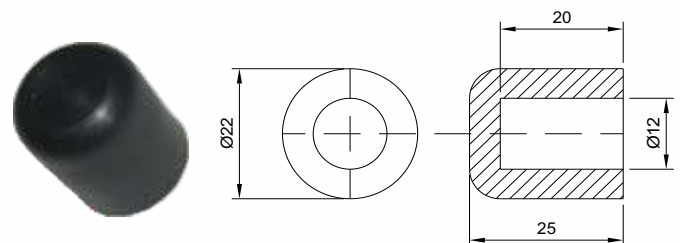

Código
CSB 2171

Material
Nitrílica

PORCA COM ARRUELA INTERNA

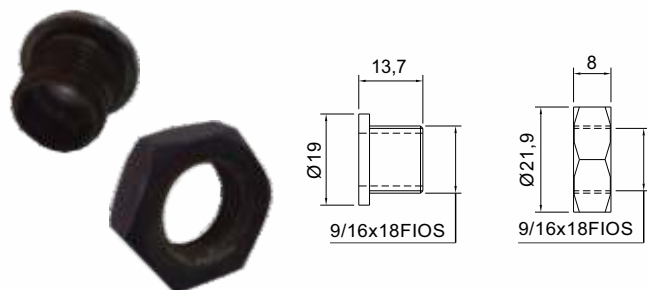

Código
CSB 3174

Material
Aço Inox

TAMPA DOS PARAFUSOS DAS ESTRELAS

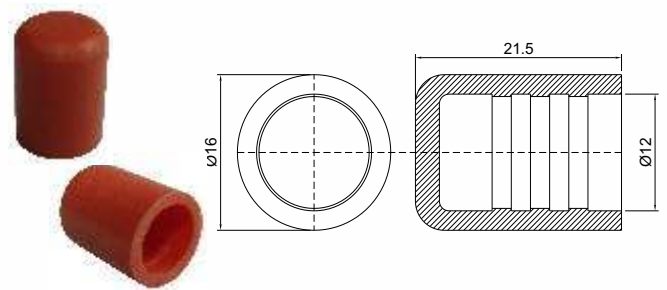

Código
CSB 4647

Material
Nitrílica

DIVERSOS

TALISCA DA MESA DIFUSORA

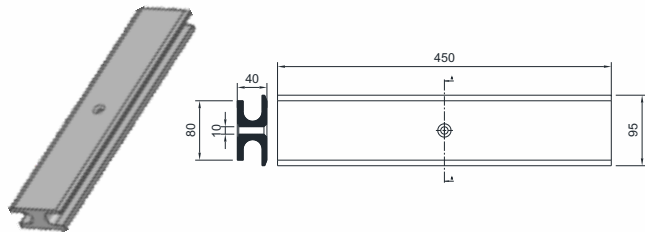

Código
CSB 7176

Material
UHMW

BORRACHA CILÍNDRICA PARA BICO DE ENCHEDORA KHS

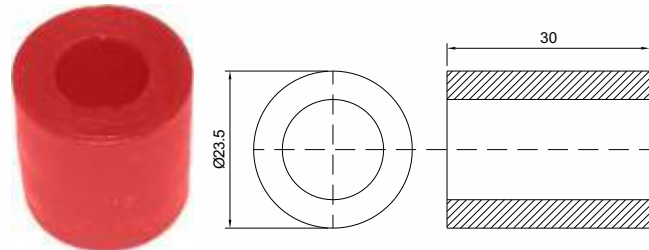

Código
CSB 4035

Material
EPDM

SIFÃO PARA INCÊNDIO

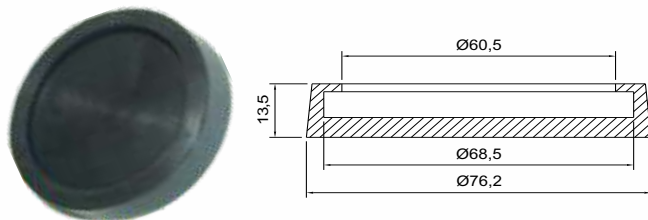

Código
CSB 0023

Material
Nitrílica

CONE DEFLETOR

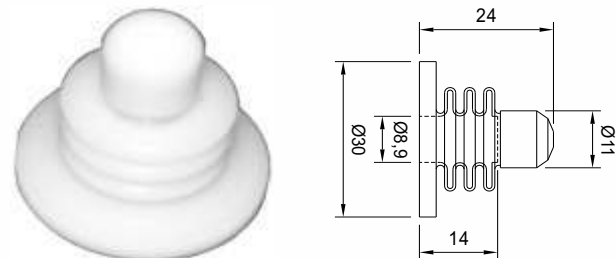

Código
CSB 4362

Material
Teflon

BICO COM ROSCA

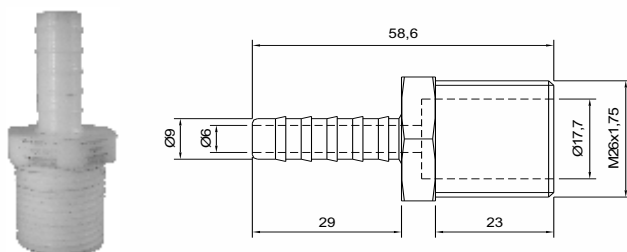

Código
CSB 3173

Material
Nylon

PEÇA PARA TRANSPORTE DE CORRENTE - TALHA DEMAG

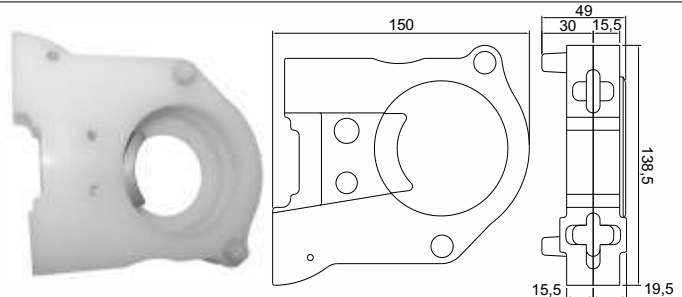

Código
CSB 4442

Material
Poliacetil

BORRACHA DE VEDAÇÃO DA PROVADEIRA

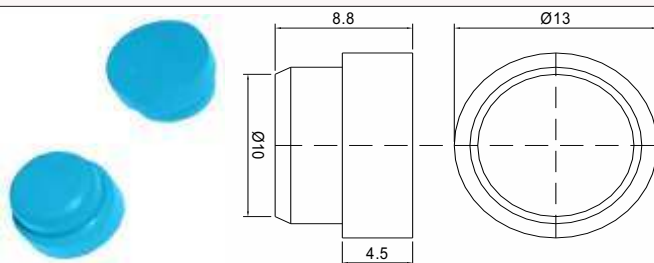

Código
CSB 2287

Material
EPDM

DESCAROÇADOR DE AZEITONA

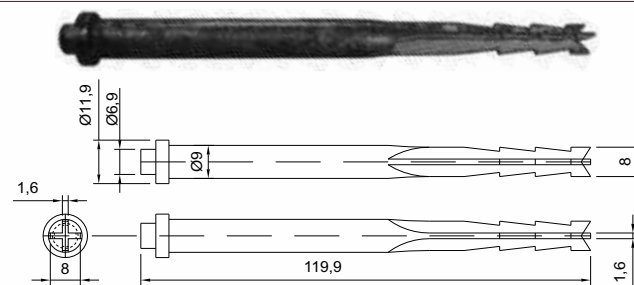

Código
CSB 4579

Material
Aço Inox Temperado

CASTROSUL INDÚSTRIA E COMÉRCIO DE PLÁSTICOS LTDA.

☎ (0XX) 41 3382-5016 ☎ (0XX) 41 3382-2643

🏠 www.castrosul.com.br ✉ castrosul@castrosul.com.br

RUA D. PEDRO II, 506 • AFONSO PENA • VILA CENTENÁRIO DO SUL

CEP 83 050-250 • SÃO JOSÉ DOS PINHAIS • PARANÁ • BRASIL

DIVERSOS

DESCAROÇADOR DE AZEITONA

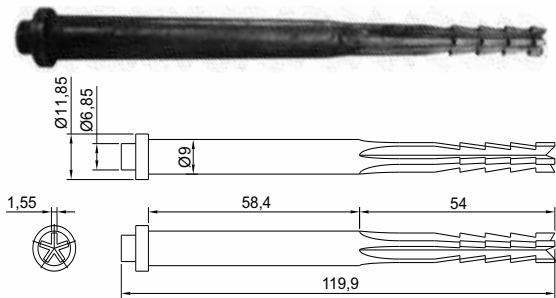

Código CSB 5686
Material Aço Inox Temperado

ROLETE

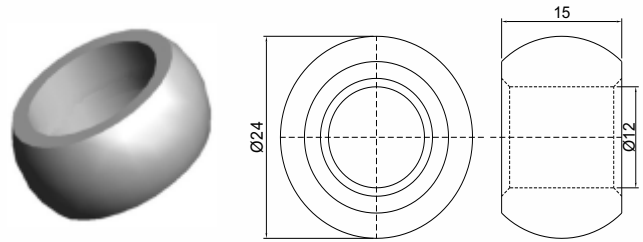

Código CSB 4292
Material Poliacetal

BORRACHA PARA DESCAROÇADOR DE AZEITONA - 9,7

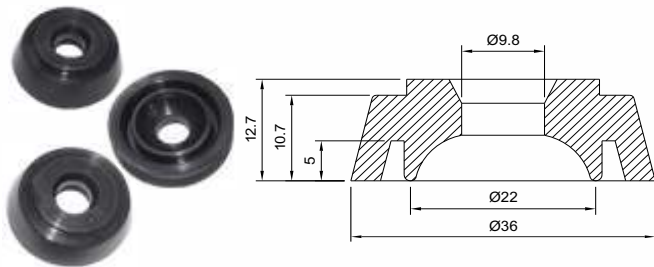

Código CSB 4377/9.7
Material Nitrilica

DIAFRAGMA PARA SOPRO

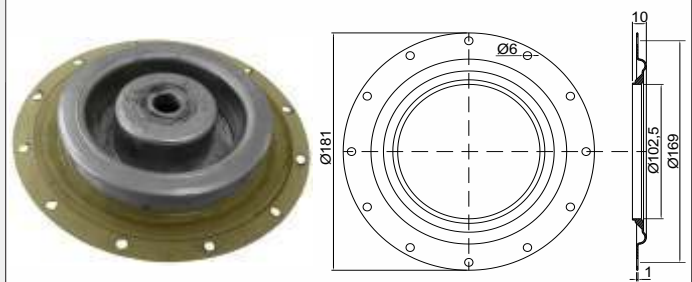

Código CSB 5308
Material P.U. e Aço

BORRACHA PARA DESCAROÇADOR DE AZEITONA - 10,7

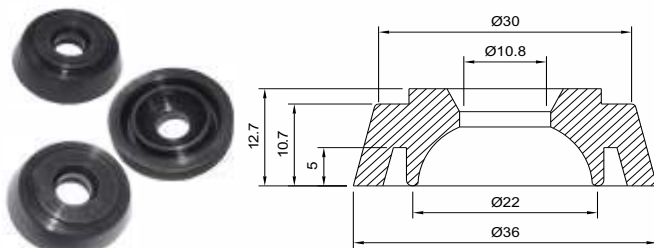

Código CSB 4377/10.7
Material Nitrilica

TARUGO

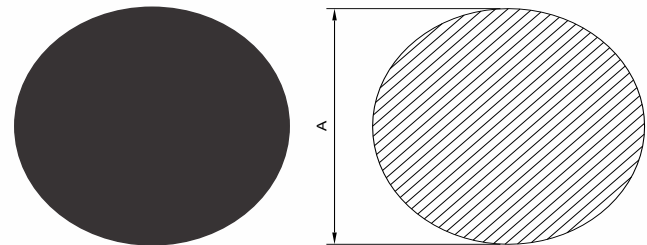

Código	A	Comprimento	Material
CSB 4503	115	300	Teflon
CSB 4504	2"	500	
CSB 4519	5"	300	
CSB 4710	1"	300	

BORRACHA PARA DESCAROÇADOR DE AZEITONA - 8,7

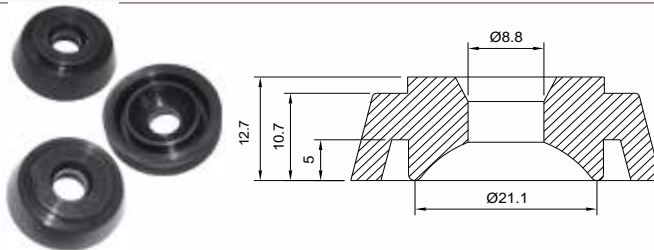

Código CSB 4377/8.7
Material Nitrilica

RODA

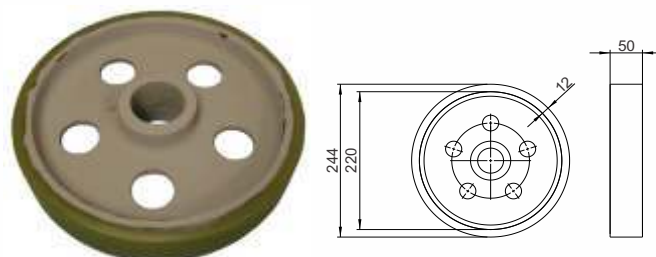

Código CSB 4851
Material Borracha EPDM e Aço

DIVERSOS

LUVA DE PRESSÃO EM INOX E BUCHA EM POLIACETAL

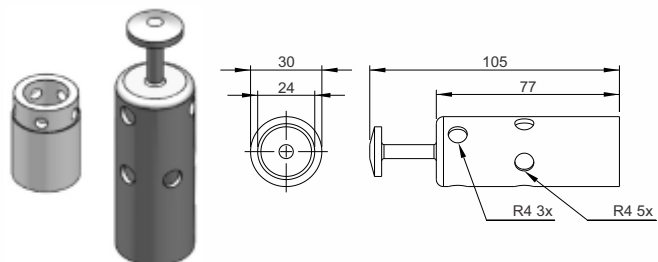

Código

CSB 5334

Material

Aço Inox e Poliacetal

BICO GRAXEIRO 10 mm RETO

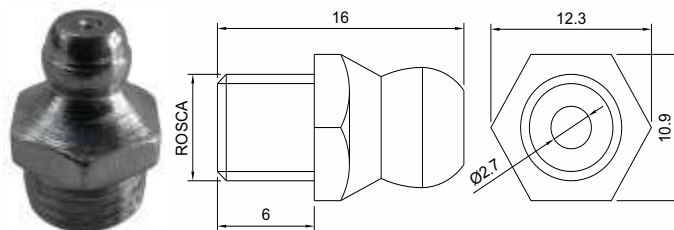

Código

CSB 5369

Material

Aço Carbono 1020

BICO GRAXEIRO 8 mm 45°

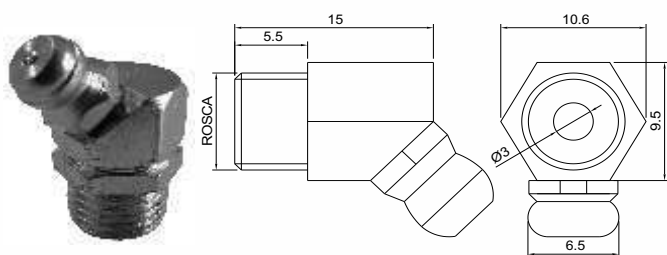

Código

CSB 5366

Material

Aço Carbono 1020

BICO GRAXEIRO 10 mm 90°

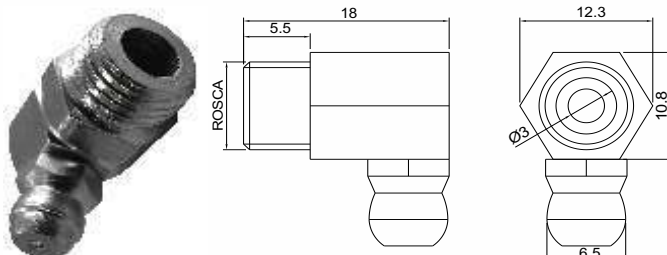

Código

CSB 5371

Material

Aço Carbono 1020

BICO GRAXEIRO 10 mm 45°

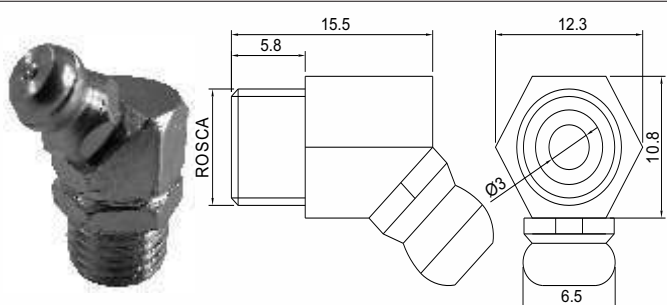

Código

CSB 5370

Material

Aço Carbono 1020

CARRETEL EM BORRACHA

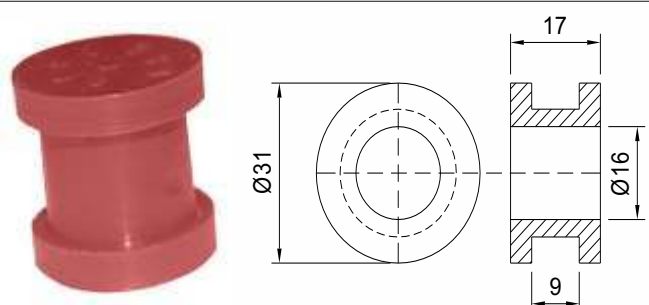

Código

CSB 5396

Material

EPDM

BICO GRAXEIRO 6 mm RETO

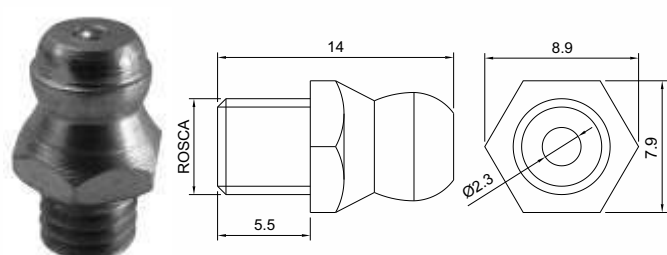

Código

CSB 5367

Material

Aço Carbono 1020

PINCEL PARA LUBRIFICAÇÃO

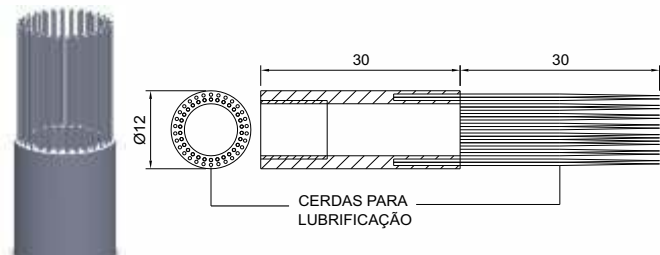

Código

CSB 5407

Material

Alumínio

GASTROSUL INDÚSTRIA E COMÉRCIO DE PLÁSTICOS LTDA.

☎ (0XX) 41 3382-5016 ☎ (0XX) 41 3382-2643

🏠 WWW.CASTROSUL.COM.BR ✉ CASTROSUL@CASTROSUL.COM.BR

RUA D. PEDRO II, 506 • AFONSO PENA • VILA CENTENÁRIO DO SUL

CEP 83 050-250 • SÃO JOSÉ DOS PINHAIS • PARANÁ • BRASIL

DIVERSOS

RETENTOR

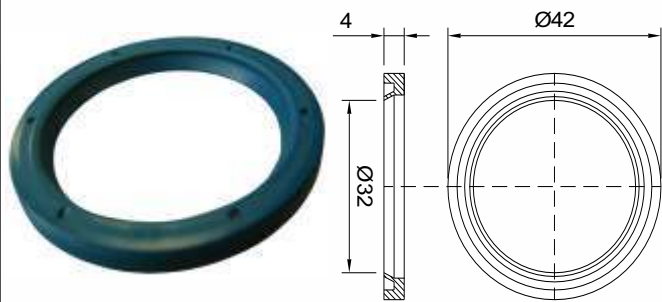

Código
CSB 5411

Material
P.U.

TUBO DE TESTE 100 ml PARA DISPERSÃO DE GÁS

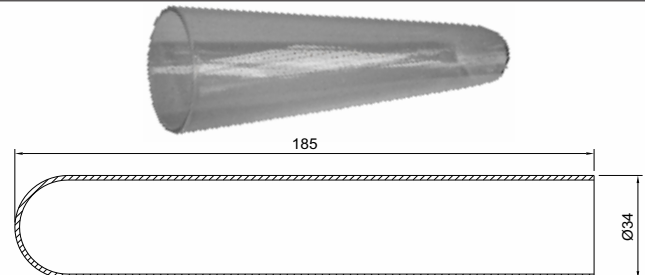

Código
CSB 4701

Material
Vidro

TUBO DE DESCARGA DO CONECTOR

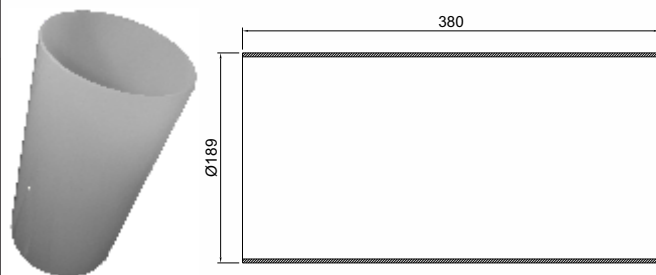

Código
CSB 4698

Material
P.P.

TUBO PARA COLETA DE GÁS

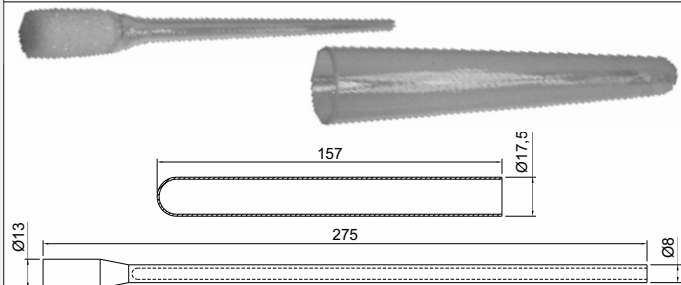

Código
CSB 4700

Material
Vidro

TUBO

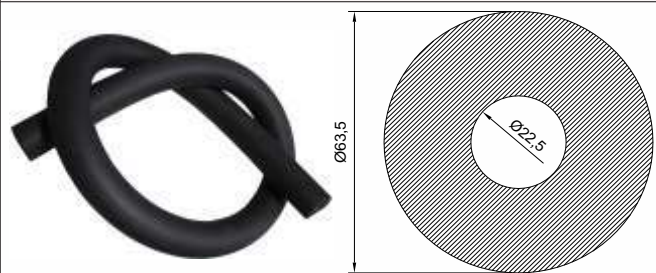

Código
CSB 4402

Material
Borracha Esponjosa

CORREIA DE TRANSMISSÃO A-56

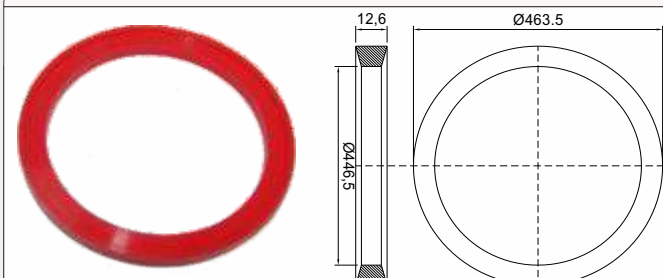

Código
CSB 5459

Material
Nitrílica

TUBO EM FIBRA DE CARBONO

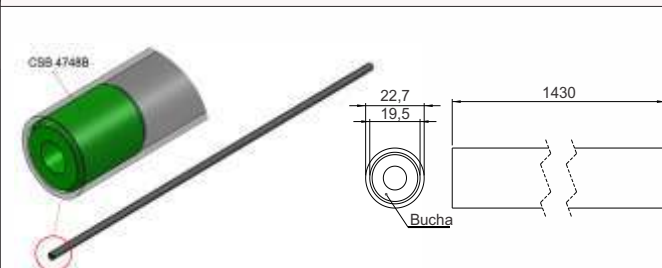

Código
CSB 4748

Material
Fibra de Carbono

TUBO 3/4"

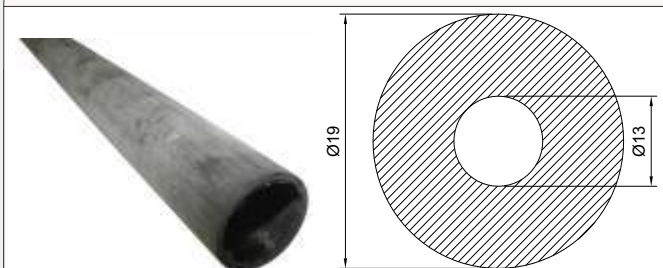

Código
CSB 5462

Material
Vidro

DIVERSOS

TUBO 5/8"

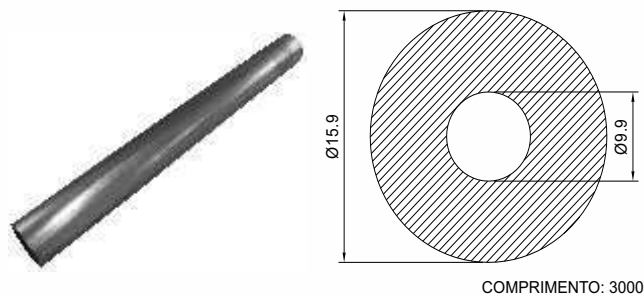

Código

CSB 5464

Material

Vidro

ARRUELA

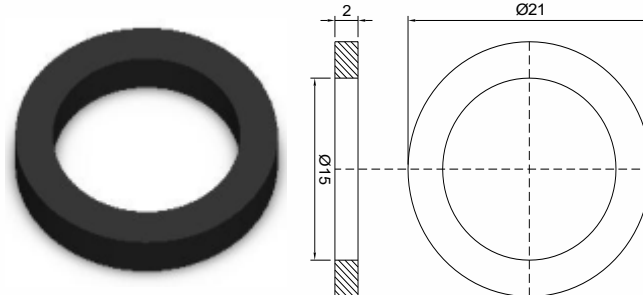

Código

CSB 4283

Material

Poliacetal

TUBO 1"

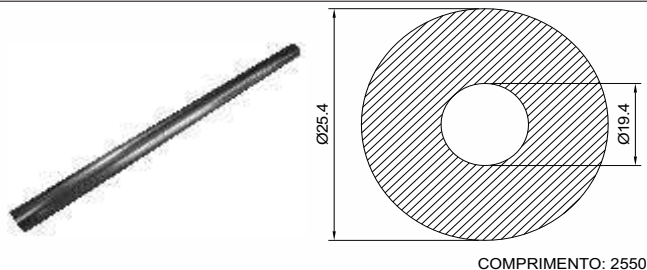

Código

CSB 5463

Material

Vidro

PARAFUSO SEXTAVADO 1,1/4"

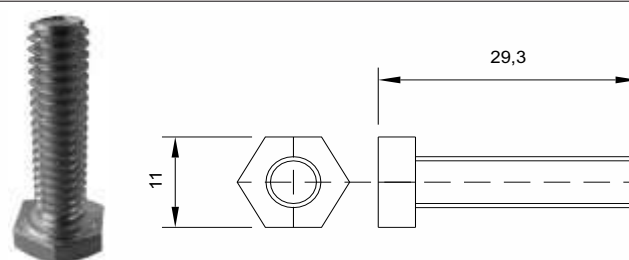

Código

CSB 5621

Material

Aço Carbono 1020 Zincado

ARRUELA LISA 1/4"

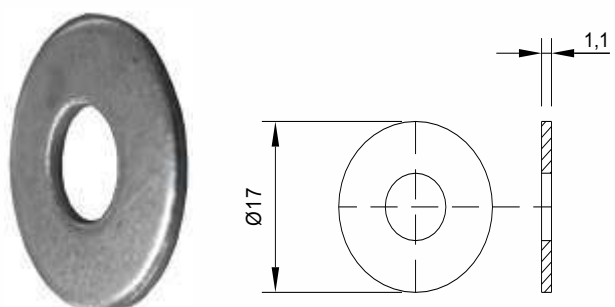

Código

CSB 5622

Material

Aço Carbono 1020 Zincado

SEPARADOR DE MACARRÃO

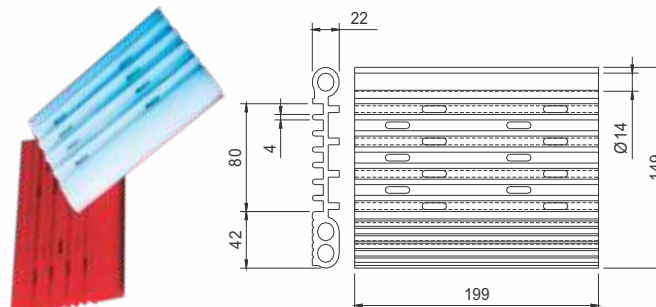

Código

CSB 8129

Material

Silicone Atóxico

ARRUELA EM BORRACHA COM LONA

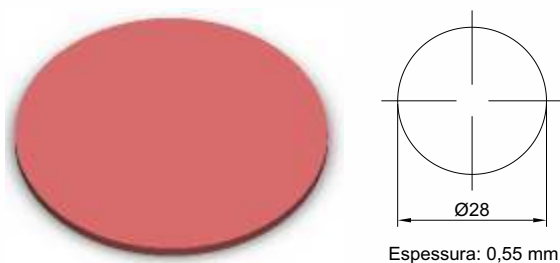

Código

CSB 4927

Material

Nitrílica

ABRAÇADEIRA PARA SEPARADOR DE MACARRÃO

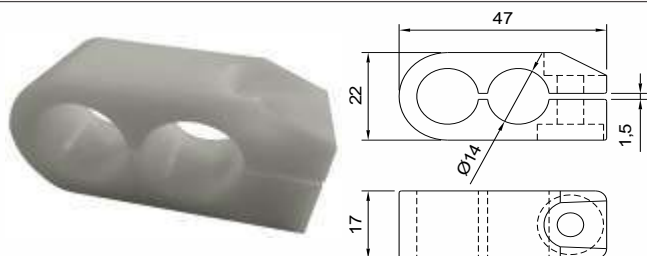

Código

CSB 4749

Material

Nylon

CASTROSUL INDÚSTRIA E COMÉRCIO DE PLÁSTICOS LTDA.

☎ (0XX) 41 3382-5016 ☎ (0XX) 41 3382-2643

🏠 www.castrosul.com.br ✉ CASTROSUL@CASTROSUL.COM.BR

RUA D. PEDRO II, 506 • AFONSO PENA • VILA CENTENÁRIO DO SUL

CEP 83 050-250 • SÃO JOSÉ DOS PINHAIS • PARANÁ • BRASIL

DIVERSOS

ABRAÇADEIRA

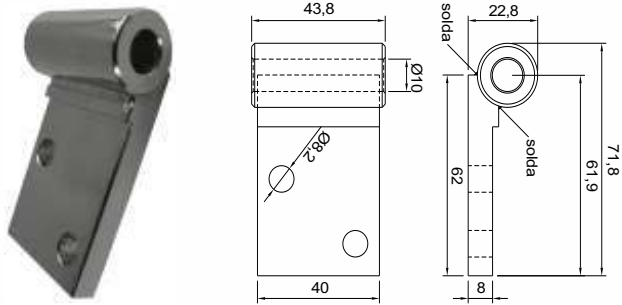

Código
CSB 4767

Material
Aço Inox

VEDAÇÃO

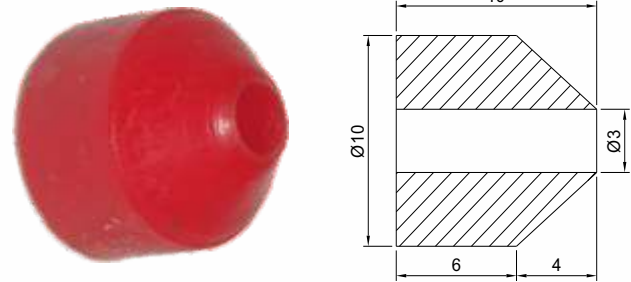

Código
CSB 2364

Material
Silicone

ABRAÇADEIRA



Medidas
de
1 a 8
Polegadas

Código
CSB 4794

Material
Aço Inox

PINO PARA TRANSPORTE

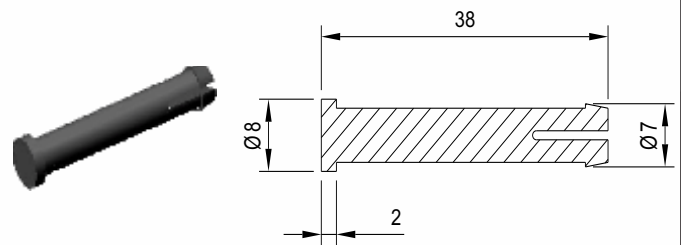

Código
CSB 3262

Material
Poliacetil

VEDAÇÃO

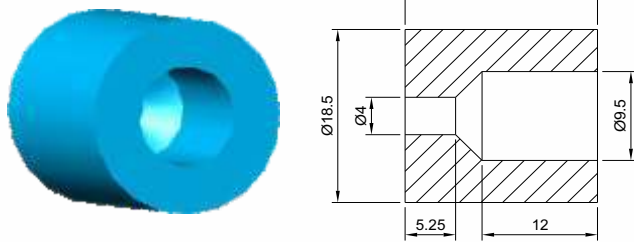

Código
CSB 2366

Material
Silicone

PINO

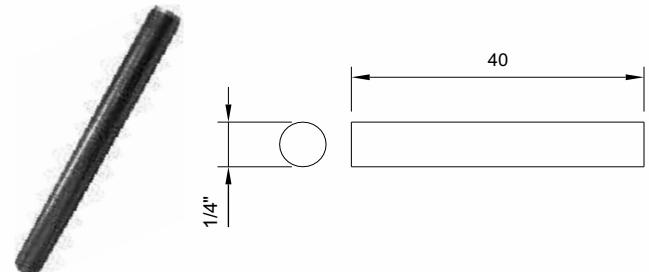

Código
CSB 5453

Material
Aço Inox

VEDAÇÃO

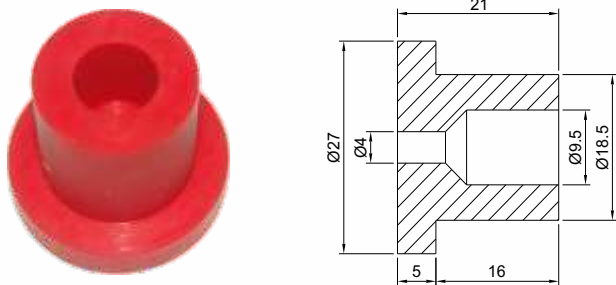

Código
CSB 2365

Material
Silicone

COLETO DA SIPA

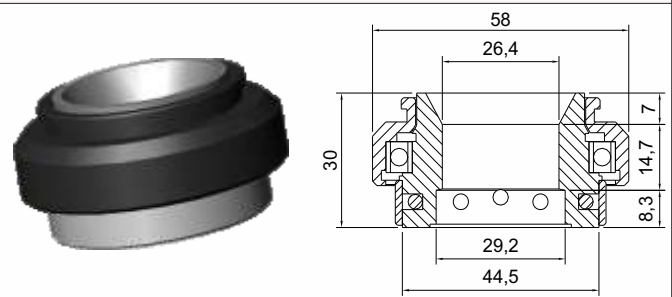

Código
CSB 2290

Material
Aço Inox Polido

DIVERSOS

GAXETA DA SOPRADORA

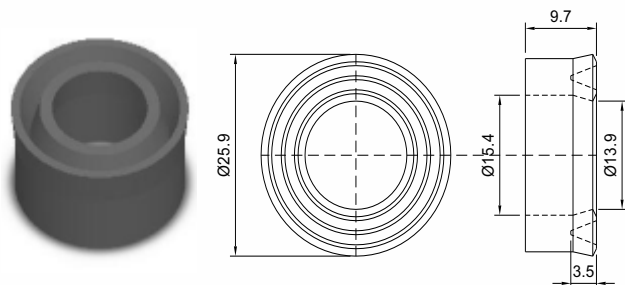

Código
CSB 5039

Material
P.U.

ASSENTO

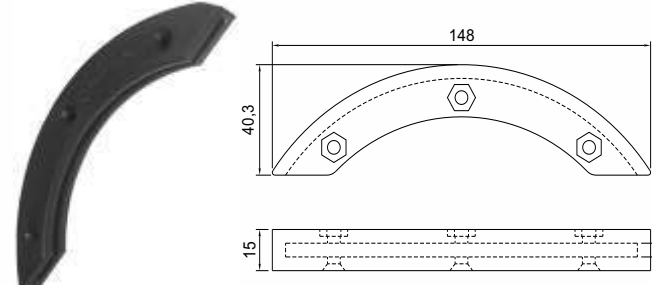

Código
CSB 4233

Material
Nylon

CORREIA

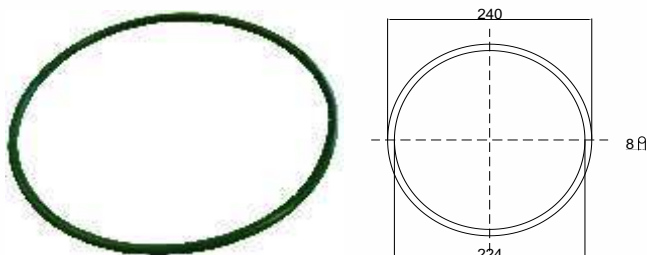

Código
CSB 4867

Material
P.U.

FUNIL DE DESCARGA DO CONECTOR

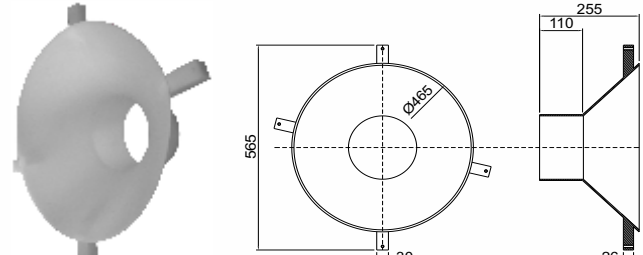

Código
CSB 4699

Material
P.P.

CINTA PARA ENSACADEIRA

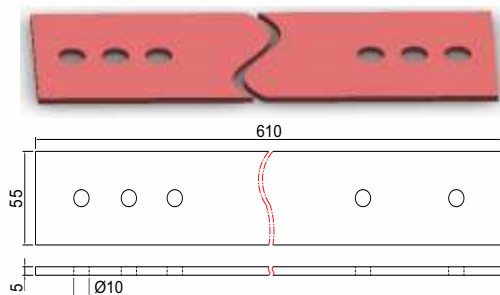

Código
CSB 4980

Material
Nitrílica

ROLETA

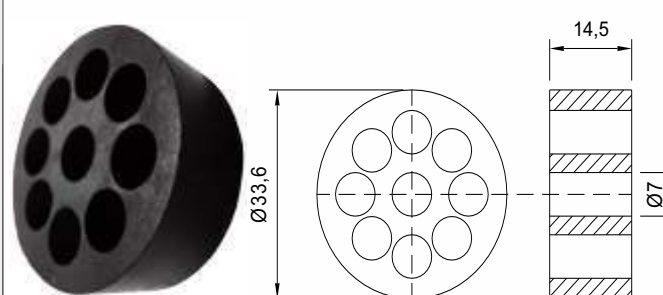

Código
CSB 4726

Material
Nitrílica

FAIXA GUIA

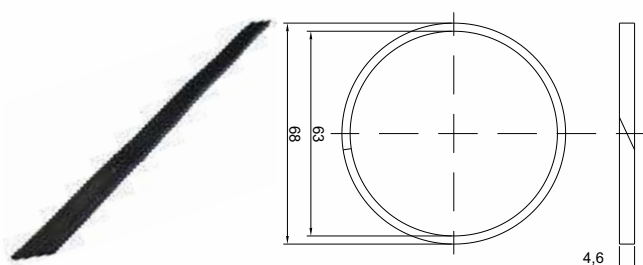

Código
CSB 4757

Material
Teflon

TAMPA PARA MANGUEIRA CERVEJEIRA

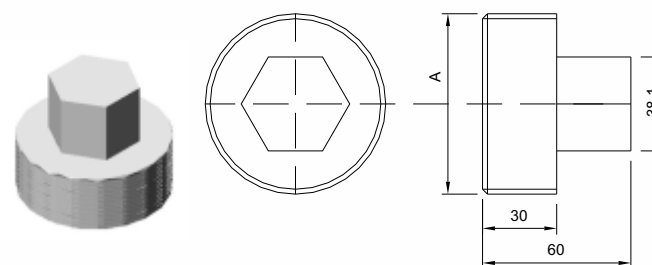

Código
CSB 1747

Mod. 2
A = 73

Mod. 3
A = 100

Mod. 4
A = 124

Material
Nylon

CASTROSUL INDÚSTRIA E COMÉRCIO DE PLÁSTICOS LTDA.

☎ (0XX) 41 3382-5016 ☎ (0XX) 41 3382-2643

🌐 WWW.CASTROSUL.COM.BR ✉ CASTROSUL@CASTROSUL.COM.BR

RUA D. PEDRO II, 506 • AFONSO PENA • VILA CENTENÁRIO DO SUL

CEP 83 050-250 • SÃO JOSÉ DOS PINHAIS • PARANÁ • BRASIL

DIVERSOS

TAMPA PLÁSTICA

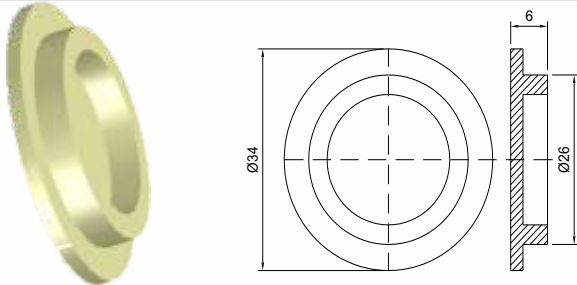

Código
CSB 3790

Material
Poliacetal

ROLDANA

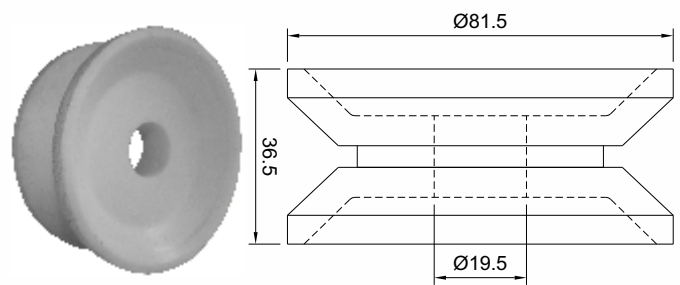

Código
CSB 3727

Material
Nylon

ACOPLAMENTO

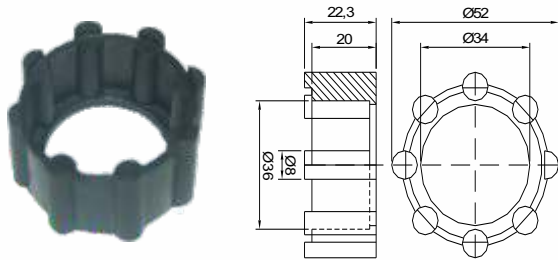

Código
CSB 1954

Material
Nitrílica

ROLDANA

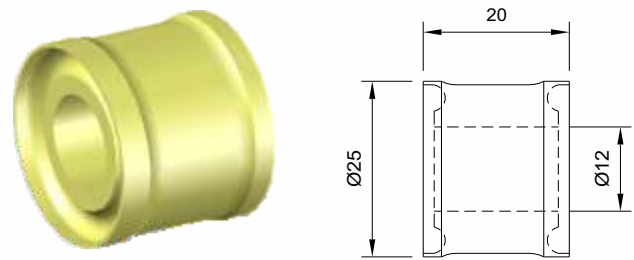

Código
CSB 3728

Material
Nylon

ACOPLAMENTO

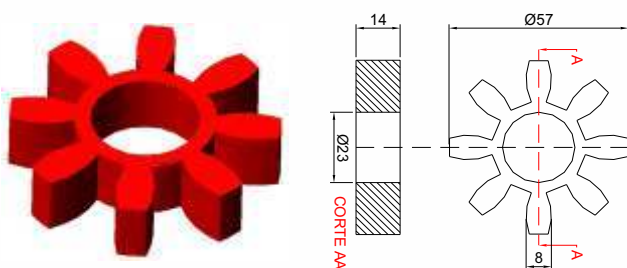

Código
CSB 3068

Material
P.U.

SELO MECÂNICO

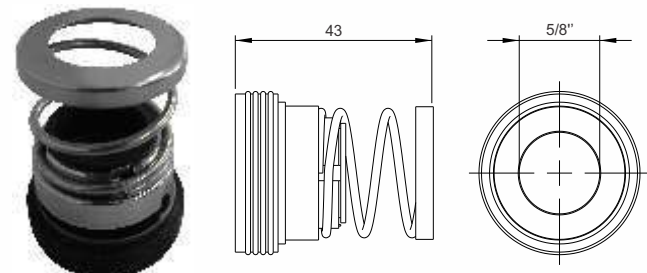

Código
CSB 7339

Material
Alumínio/Aço Inox/Nitrílica

ARRUELA

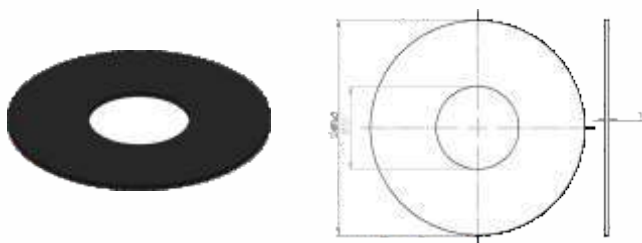

Código
CSB 7257

Material
Borracha Nitrílica

SELO MECÂNICO

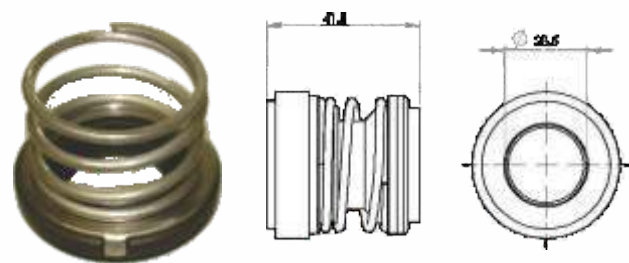

Código
CSB 8707

Material
LATÃO

DIVERSOS

SELO MECÂNICO

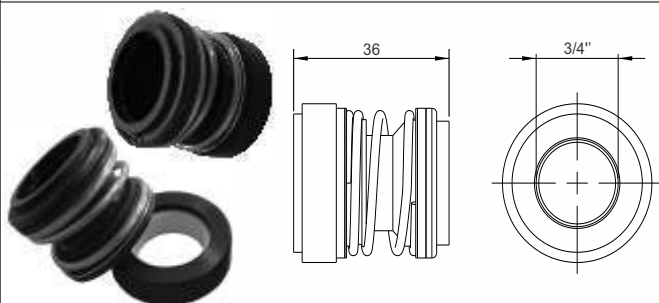

Código
CSB 7340

Material
Alumínio e Aço Inox

BORRACHA RETANGULAR

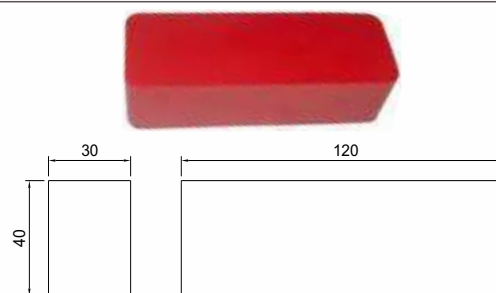

Código
CSB 4044

Material
Silicone Atóxico

SUPOORTE DE TAMPAS

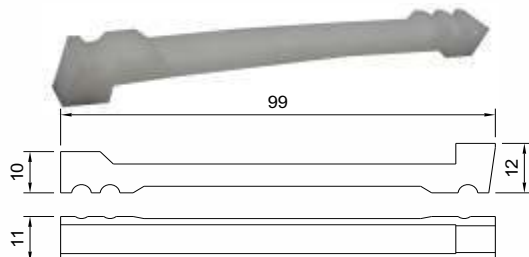

Código
CSB 4720

Material
Nylon

CAPA PARA ROLAMENTO

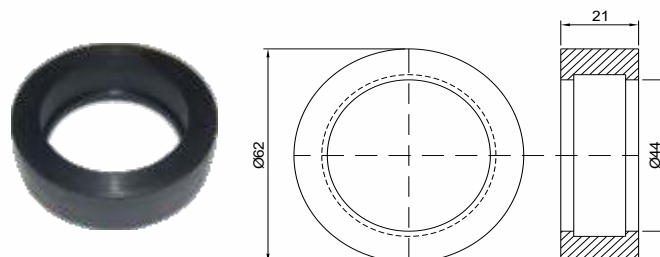

Código
CSB 3310

Material
EPDM

ROSCA DOSADORA TOVER

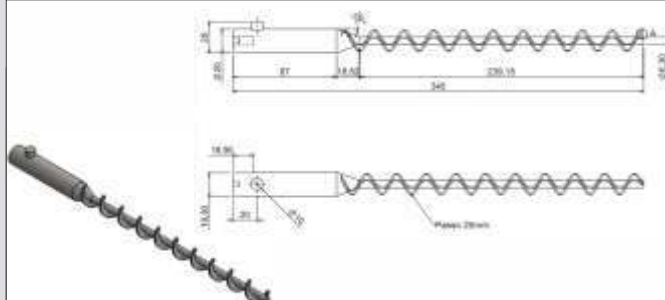

Código
CSB 10035

Material
Aço Inóx

ANEL DE TEFLON

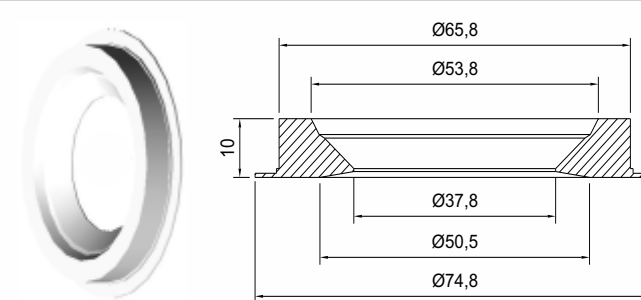

Código
CSB 2330

Material
Teflon

BICO PARA ASPIRADOR INDUSTRIAL

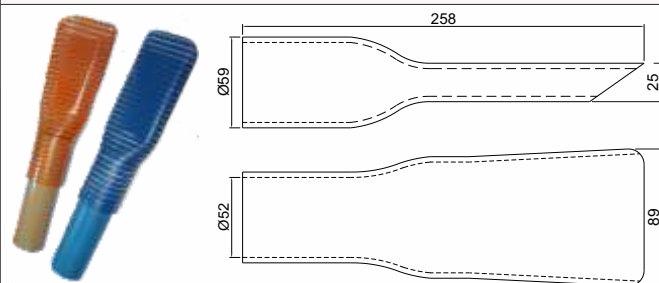

Código
CSB 4211

Material
PVC

ANEL ELÁSTICO

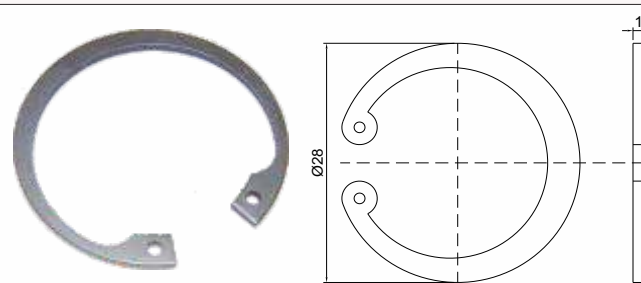

Código
CSB 3791

Material
Aço

CASTROSUL INDÚSTRIA E COMÉRCIO DE PLÁSTICOS LTDA.

☎ (0XX) 41 3382-5016 ☎ (0XX) 41 3382-2643

🏠 WWW.CASTROSUL.COM.BR ✉ CASTROSUL@CASTROSUL.COM.BR

RUA D. PEDRO II, 506 • AFONSO PENA • VILA CENTENÁRIO DO SUL

CEP 83 050-250 • SÃO JOSÉ DOS PINHAIS • PARANÁ • BRASIL

DIVERSOS

SUPOORTE EM NYLON

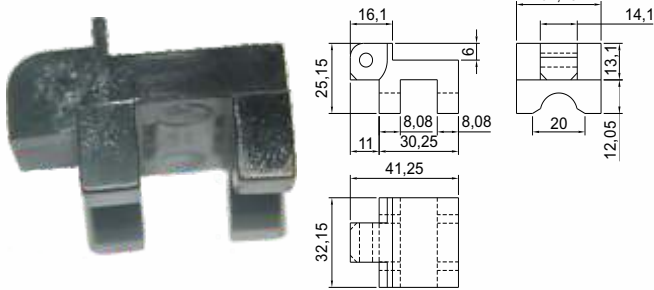

Código

CSB 3171

Material

Nylon Preto

SUPOORTE EM NYLON

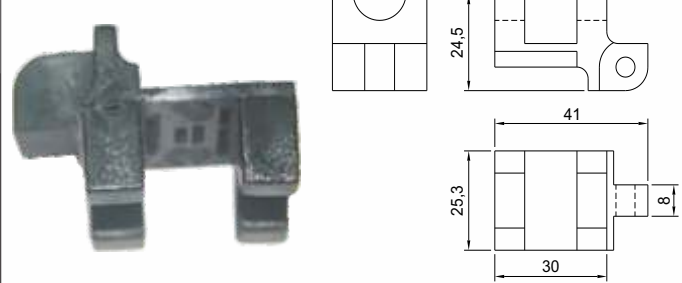

Código

CSB 3282

Material

Nylon Termoestabilizado Preto

SUPOORTE EM NYLON

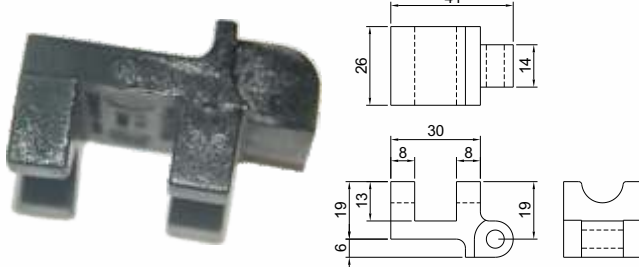

Código

CSB 3169

Material

Nylon Preto

SUPOORTE EM NYLON

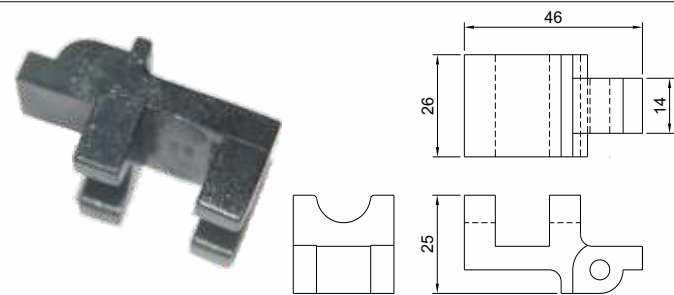

Código

CSB 3281

Material

Nylon Termoestabilizado Preto

SUPOORTE EM NYLON

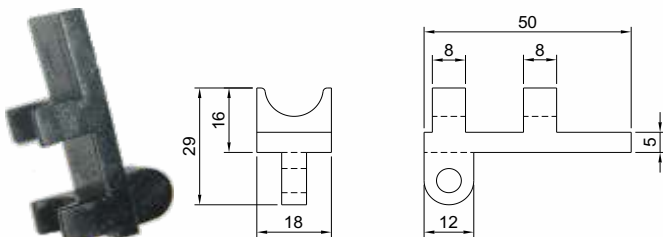

Código

CSB 3164

Material

Nylon Preto

CONEXÃO PARA COLETA DE AR COMPRIMIDO

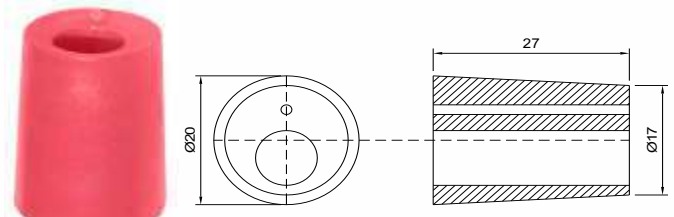

Código

CSB 4199

Material

Silicone Atóxico

SUPOORTE EM NYLON

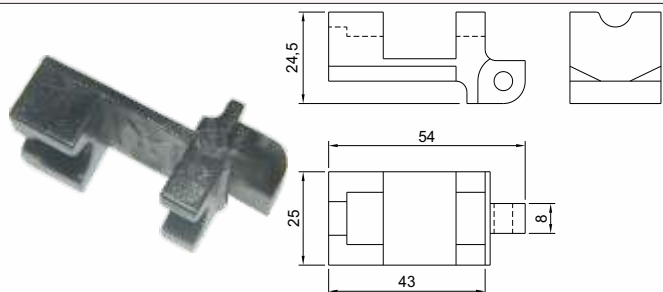

Código

CSB 3280

Material

Nylon Termoestabilizado Preto

ISOLADOR

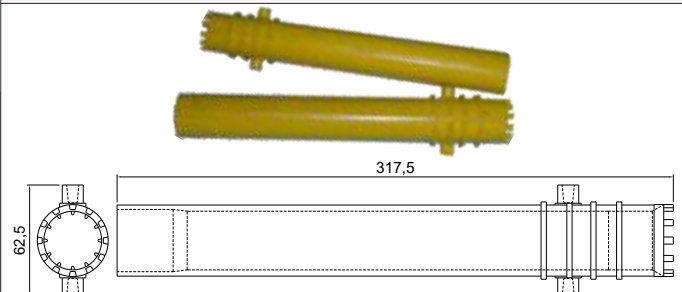

Código

CSB 4178

Material

Nitrílica ou P.U.

DIVERSOS

EIXO

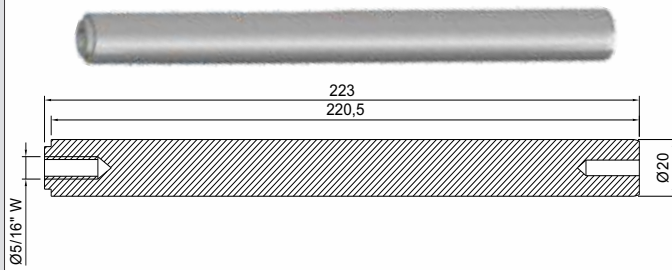

Código CSB 3788
Material Aço Inox Polido

MANCAL PARA ROLAMENTO

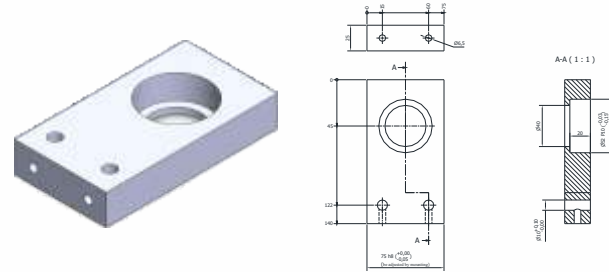

Código CSB 8691
Material UHMW

EIXO TULIPA

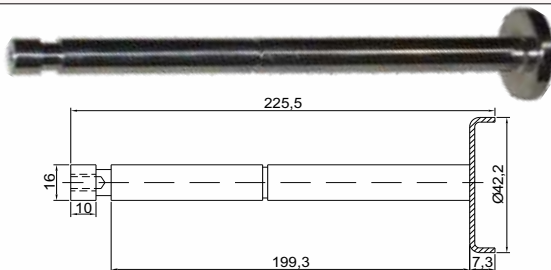

Código CSB 3868
Material Aço Inox Polido

PROTEÇÃO

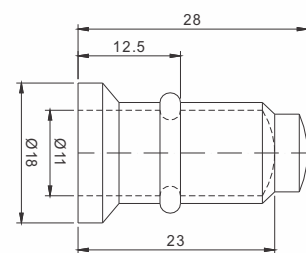

Código CSB 0771
Material Silicone Atóxico

PLACA

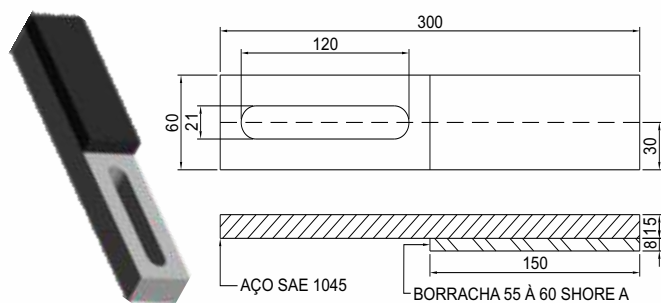

Código CSB 2200
Material Aço SAE e Borracha Dureza 55 a 60 Shore "A"

TAMPA DE BORRACHA PARA PEÇA DO CILINDRO

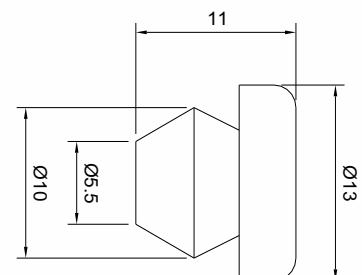

Código CSB 2138 PC
Material Nitrílica

SELO DE VEDAÇÃO

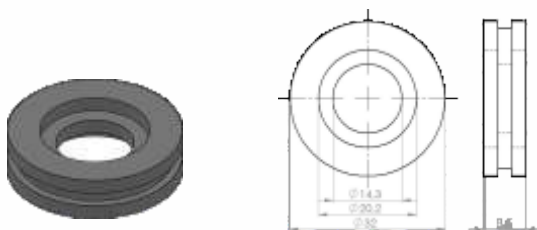

Código CSB 7251
Material Aço Inóx

TUBO VEDANTE

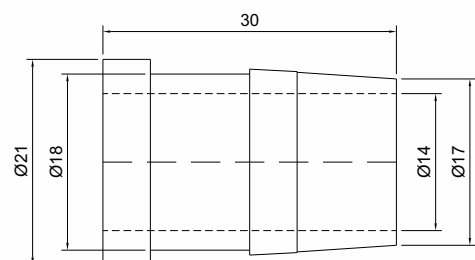

Código CSB 2089
Material Teflon

CASTROSUL INDÚSTRIA E COMÉRCIO DE PLÁSTICOS LTDA.

☎ (0XX) 41 3382-5016 ☎ (0XX) 41 3382-2643

🌐 WWW.CASTROSUL.COM.BR ✉ CASTROSUL@CASTROSUL.COM.BR

RUA D. PEDRO II, 506 • AFONSO PENA • VILA CENTENÁRIO DO SUL

CEP 83 050-250 • SÃO JOSÉ DOS PINHAIS • PARANÁ • BRASIL

DIVERSOS

FOLE DE PROTEÇÃO

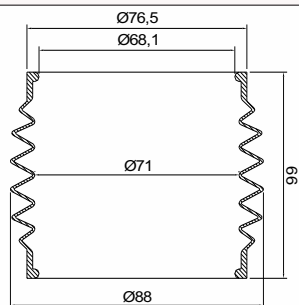

Código

CSB 2084

Material

Nitrílica

PEÇA DE PRESSÃO

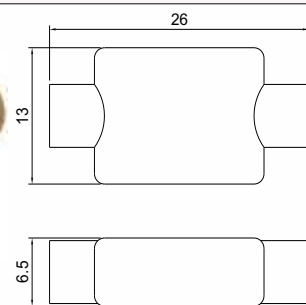

Código

CSB 1250

Material

Nitrílica

FOLE

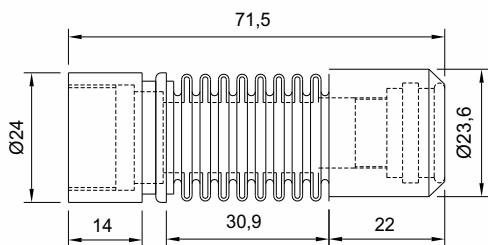

Código

CSB 4363

Material

Teflon

PEÇA QUADRADA COM MEIA-LUA

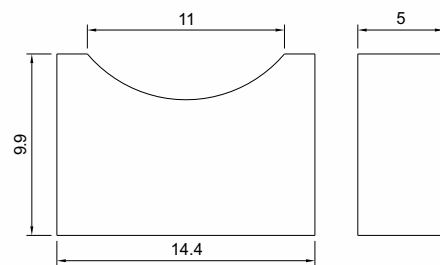

Código

CSB 3887

Material

P.U.

PEÇA DO CILINDRO COM BUCHA INOX

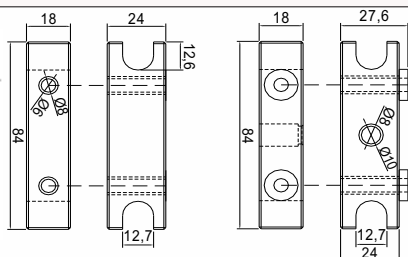

Código

CSB 2138

Material

UHMW e Aço Inox

PERFIL DE AÇO COM BORRACHA PARA VEDAÇÃO PÓ FARINHA

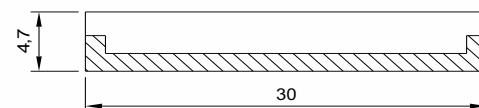

Código

CSB 3305

Material

Aço Inox e Nitrílica

PÉ DE P.U. PARA POSTO MIX

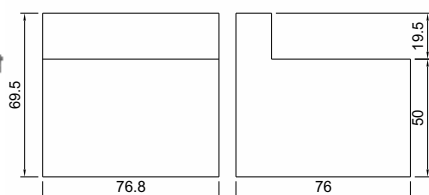
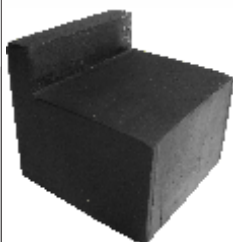

Código

CSB 4170

Material

P.U.

PINÇA DO PESCOÇO

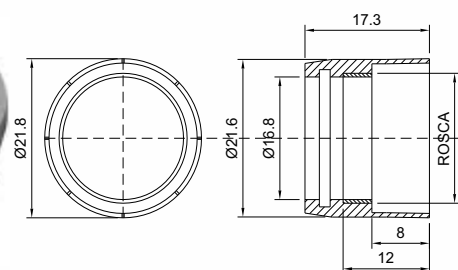

Código

CSB 3962

Material

Aço Inox Polido

DIVERSOS

PINHÃO DE AÇO COM ACOPLAMENTO EM NYLON

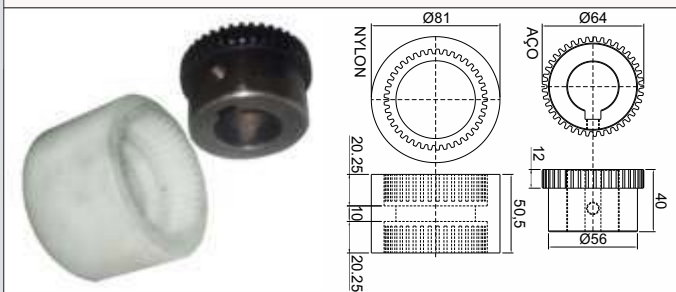

Código

CSB 3599

Material

Aço Tratado e Nylon

EMPURRADOR DA SERRA DO WAFER 1

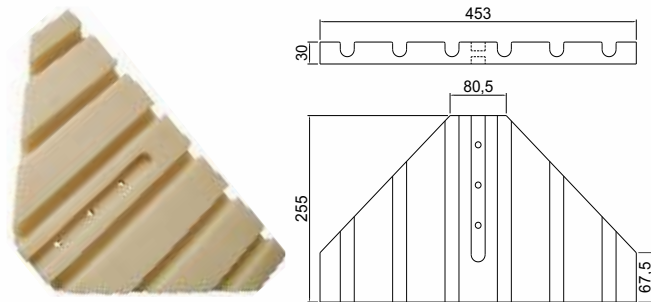

Código

CSB 4130

Material

UHMW

PLACA DE TRANSPORTE DA DRAGA

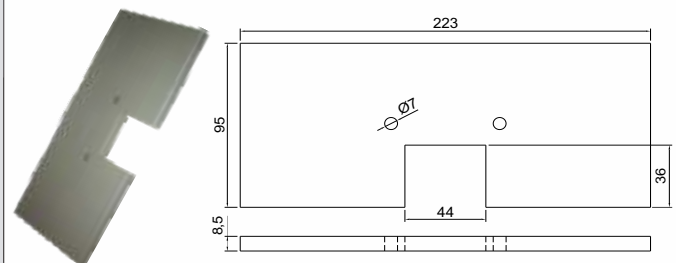

Código

CSB 3930

Material

P.P.

EMPURRADOR DA SERRA DO WAFER 2

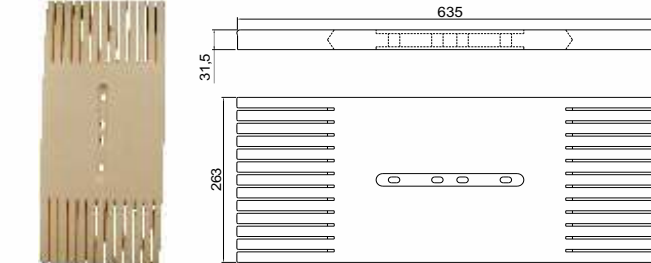

Código

CSB 4131

Material

UHMW

PONTEIRA COM CANAIS NA LATERAL

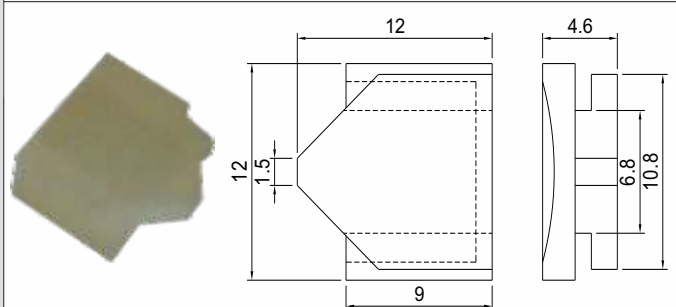

Código

CSB 3886

Material

P.U.

GUIA

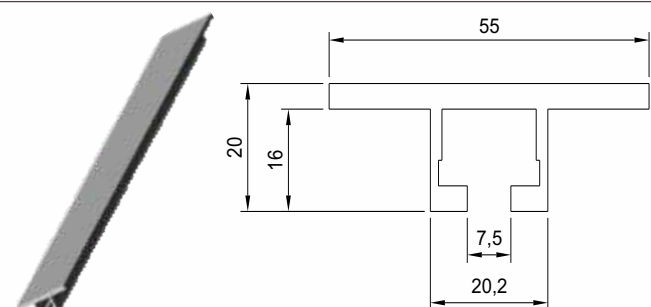

Código

CSB 3355

Material

Alumínio

PERFIL PARA ALTA TEMPERATURA

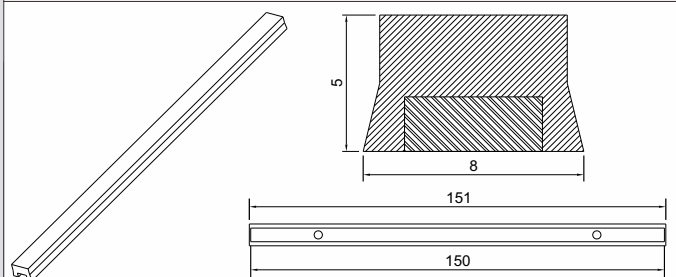

Código

CSB 4627

Material

Bronze/Silicone

PARAFUSO COM MOLA INTERNA

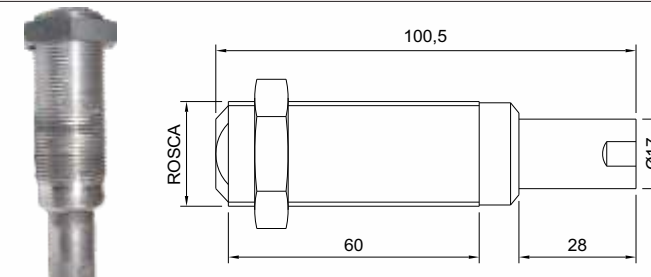

Código

CSB 4431

Material

Alumínio

CASTROSUL INDÚSTRIA E COMÉRCIO DE PLÁSTICOS LTDA.

☎ (0XX) 41 3382-5016 ☎ (0XX) 41 3382-2643

🏠 www.castrosul.com.br ✉ castrosul@castrosul.com.br

RUA D. PEDRO II, 506 • AFONSO PENA • VILA CENTENÁRIO DO SUL

CEP 83 050-250 • SÃO JOSÉ DOS PINHAIS • PARANÁ • BRASIL

DIVERSOS

GUIA DO FILTRO DA SEITZ

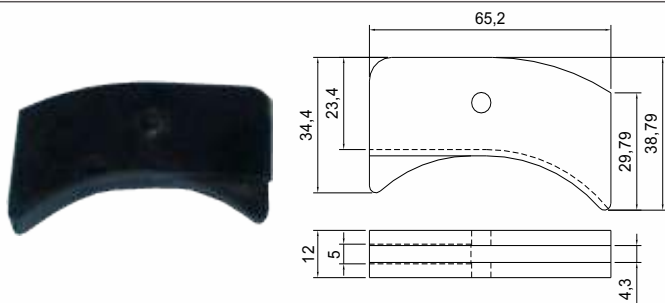

Código
CSB 2357

Material
UHMW

PERFIL GUIA PARA CINTA

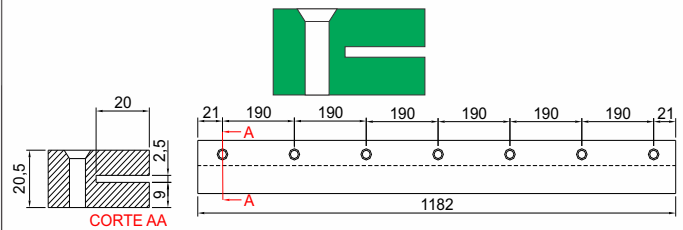

Código
CSB 3066

Material
UHMW

HASTE

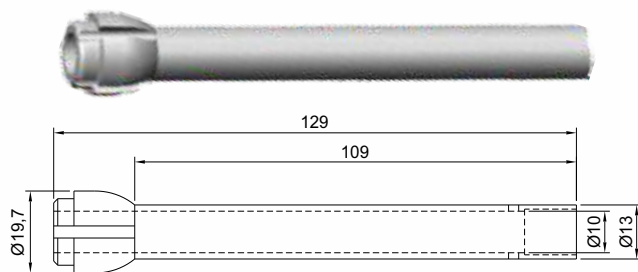

Código
CSB 3439

Material
Poliacetil

CONECTOR BAG

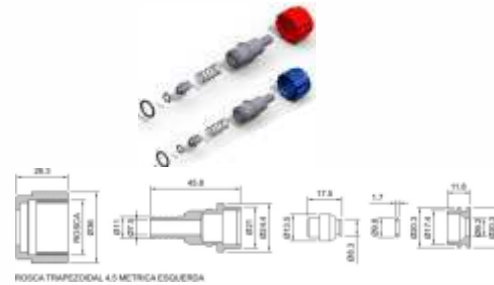

Código
CSB 8222
CSB 8223

Material
Poliacetil

COXIM AMORTECEDOR

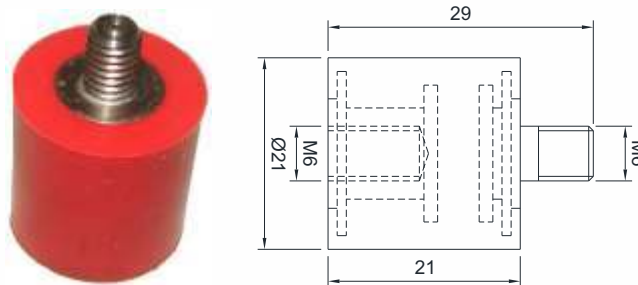

Código
CSB 10008

Material
Silicone Atóxico e Aço Inóx

EIXO ROSCADO

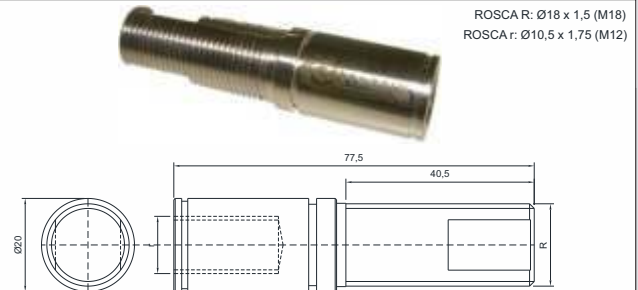

Código
CSB 10346

Material
Aço Inóx

PORCA SEXTAVADA PARA EIXO

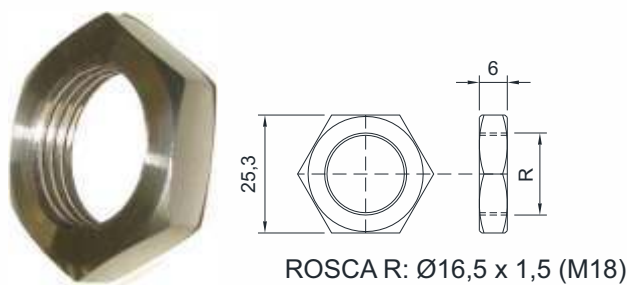

Código
CSB 10347

Material
Aço Inóx

SUPORTE DE EIXO ROSCADO

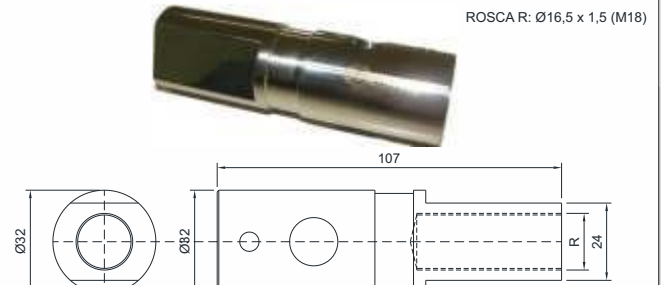

Código
CSB 10348

Material
Aço Inóx

DIVERSOS

LÂMINA DE CORTE

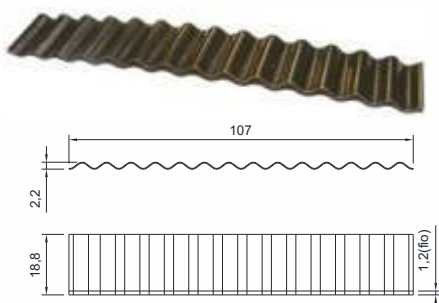

Código
CSB 10240

Material
Aço Inóx

LÂMINA DE CORTE

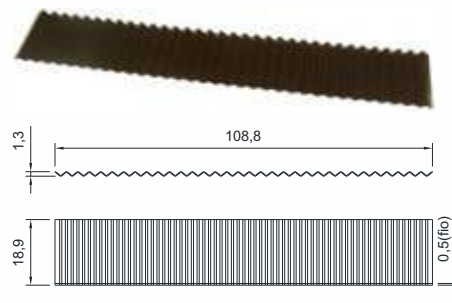

Código
CSB 10241

Material
Aço Inóx

LÂMINA DE CORTE

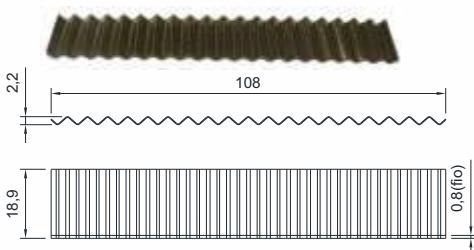

Código
CSB 10242

Material
Aço Inóx

LÂMINA DE CORTE

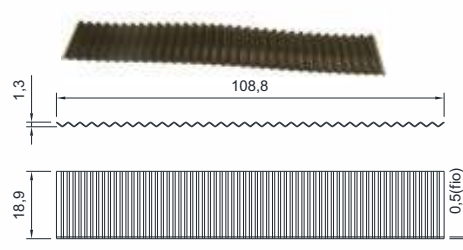

Código
CSB 10243

Material
Aço Inóx

GUIA

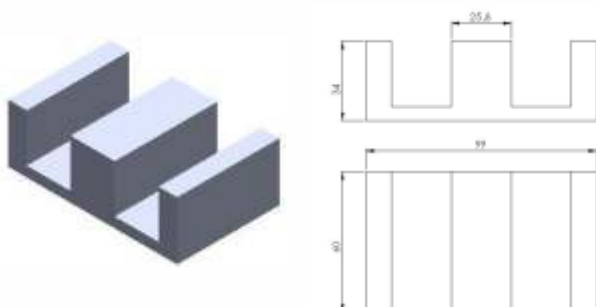

Código
CSB 9548

Material
UHMW

GUIA

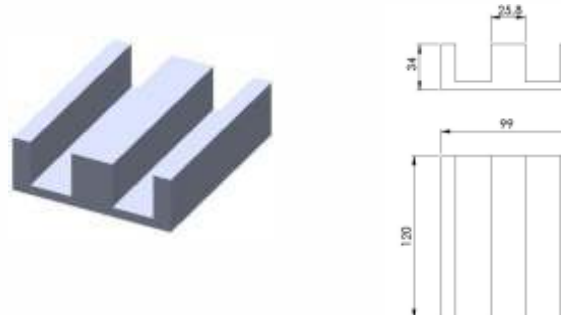

Código
CSB 9549

Material
UHMW

PERFIL

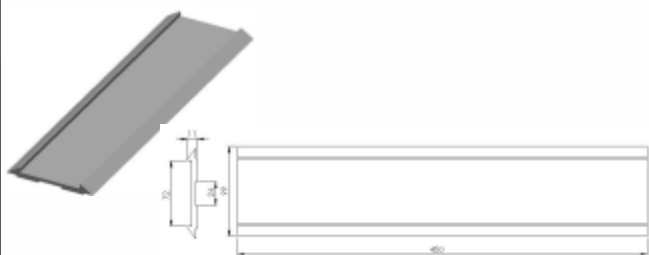

Código
CSB 9550

Material
UHMW

BARRA DO FILME EMPACOTADORA

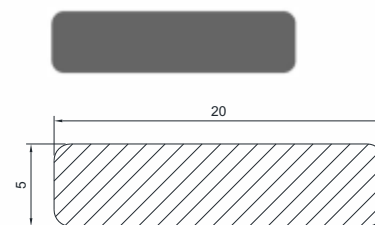

COMPRIMENTO: 770mm

Código
CSB 10384

Material
Alumínio

CASTROSUL INDÚSTRIA E COMÉRCIO DE PLÁSTICOS LTDA.

☎ (0XX) 41 3382-5016 ☎ (0XX) 41 3382-2643

🏠 WWW.CASTROSUL.COM.BR ✉ CASTROSUL@CASTROSUL.COM.BR

RUA D. PEDRO II, 506 • AFONSO PENA • VILA CENTENÁRIO DO SUL

CEP 83 050-250 • SÃO JOSÉ DOS PINHAIS • PARANÁ • BRASIL

DIVERSOS

CORREIA PLANA

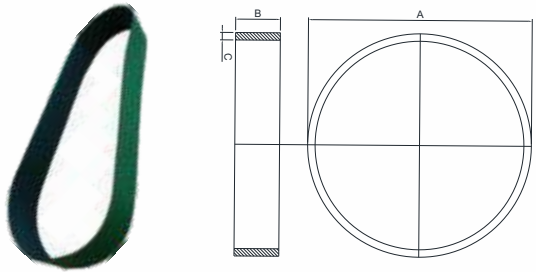

Código	A	B	C	Material
CSB 11987				Poliéster com Borracha
CSB 11988				
CSB 5472	450	25	0,7	

GOTEJADOR DE ÓLEO

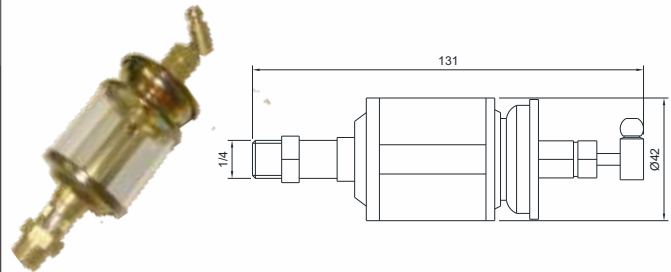

Código	Material
CSB 8357	BRONZE BUCHA

SELO MECÂNICO

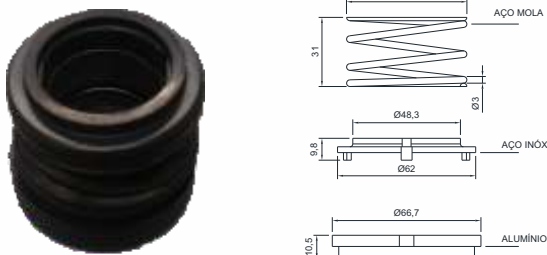

Código	Material
CSB 4624	Alumínio

KIT DIAFRAGMA DE VÁLVULA DE P.U.

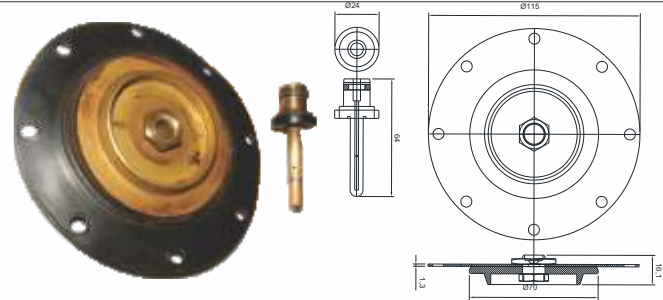

Código	Material
CSB 7873	Borracha Nitrílica

SELO MECÂNICO



Código	Material
CSB 4623	Alumínio

DIAFRAGMA COM LONA INTERNA

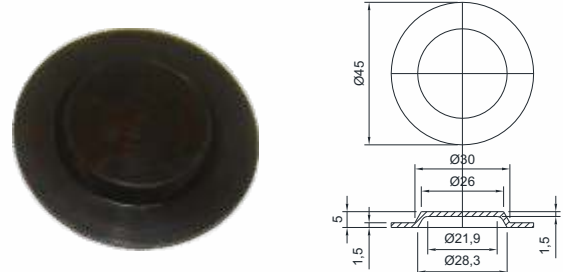

Código	Material
CSB 8212	Borracha Nitrílica

PÉ DE BORRACHA PARA MAQUINA

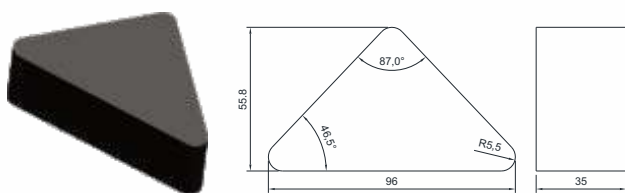

Código	Material
CSB 7874	Borracha Nitrílica

DIAFRAGMA

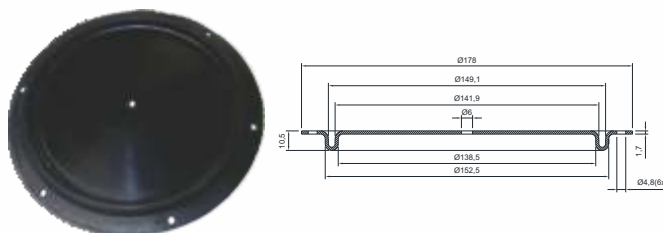

Código	Material
CSB 8408	Borracha Nitrílica